

**ADDENDUM NO. 2**  
**21<sup>ST</sup> AVENUE SW PRESERVATION PROJECT**  
**PROJECT #36253**

**ATTENTION ALL BIDDERS AND PLANHOLDERS:** You are hereby notified that the Bid and Contract Documents are amended as follows:

**A) CLARIFICATIONS**

**(1) RRFB MODIFICATION LOCATIONS**

- A question was submitted requesting clarification on the three locations for RRFB modifications. They are as follows:

- (1) The mid-block crossing between SW 339<sup>th</sup> St and SW 338<sup>th</sup> St.
- (2) The mid-block crossing between SW 330<sup>th</sup> St and SW 328<sup>th</sup> St
- (3) The mid-block crossing just south of SW 322<sup>nd</sup> PI

There was a callout #23 mistakenly shown at the intersection of SW 334<sup>th</sup> St that has been corrected. There is not an RRFB at this location.

**(2) MATERIAL TESTING**

- A question was submitted requesting clarification on material testing. The City of Federal Way will contract with a material testing company to complete concrete strength tests of concrete for flat work and compaction testing results for HMA taken in locations directed by the City. The City's contracted HMA tester may not be on-site for the entire duration of paving work. Therefore, the Contractor may opt to have their own material tester on site, especially during HMA paving, to ensure they are getting compaction throughout the project. If the Contractor opts to have their own tester on site, this would be incidental to other bid items.

**(3) MATERIAL TRANSFER DEVICE / VEHICLE**

- A question was submitted requesting clarification on whether a MTD/V is desired or required by the City. The City does not require the use of an MTD/V and will not direct the Contractor that they are required to use one. If the Contractor desires to use a MTD/V, they must submit this request to the City during construction for approval.

**(4) WORK HOURS / PEAK HOURS**

- A question was submitted requesting clarification on working hours and whether there will be any restrictions during peak vehicle hours.
  - Per Special Provision Section 1-08.0(2), the normal working hours are any consecutive 8-hour period between 7:00 a.m. and 6:00 p.m., Monday through Friday, exclusive of a lunch break.
  - Per Special Provision Section 1-08.0(2), the Contractor may request extend work hours on days when paving operations are occurring. Work hours may be modified to 7:00 a.m. to 5:30 p.m.
  - There are no restrictions during peak vehicle hours. However, per Standard Specification Section 2-03.3(1) "If the Engineer determines the permitted closure hours adversely affect traffic, the Engineer may adjust the hours accordingly." The City acknowledges there are high traffic volumes within the project limits and that there will be significant impacts to traffic.

**B) CONTRACT DOCUMENTS**

*DELETE the original sheets and REPLACE with the attached pages which include the following change(s):*

**(1) PAGES RFB-5 - RFB-7, BID PROPOSAL**

- Bid Item numbers have been adjusted to reflect for deleted/added bid items.
- Spec References in the Bid Proposal table have been adjusted to reflect new spec references with the 2026 WSDOT Standard Specifications.
- Bid Item #12 – Roadside Cleanup: This bid item has been deleted. It is not applicable to this project.
- Bid Item #12 – Work Zone Safety Contingency: The FA price has been revised from \$1,500 to \$20,000.
- Bid Item #13 – Uniformed Police Officer: This is a new bid item.
- Bid Item #14 – Roadway Excavation, Incl. Haul: The quantity has been revised from 1,030 CY to 0 CY and the bid item has been deleted. Note that the WSDOT Standard Specifications and Special Provision Section 8-04.5 and 8-14.5 indicate that excavation, including haul is incidental to bid items such as sidewalk, curb and gutter, cement conc. curb ramps, and pedestrian curbs, etc.
- Bid Item #16 – HMA Cl. ½” PG58H-22: The quantity has been revised from 7,520 TN to 5,600 TN. This reflects that a new bid item has been created for HMA for pavement repair.
- Bid Item #17 – HMA for Pavement Repair Cl. ½” PG58H-22: This is a new bid item.
- Bid Item #18 – Planing Bituminous Pavement: The quantity has been revised from 12,900 SY to 40,000 SY.
- Bid Item #19 – Pavement Repair Excavation, Incl. Haul: This is a new bid item.
- Bid Item #20 – Adjust Catch Basin: The quantity has been revised from 54 EA to 15 EA.
- Bid Item #25 – Property Restoration: The FA price has been revised from \$3,000 to \$10,000.
- Bid Item #29 – Concrete Precast Dual Sloped Mountable Curb: The quantity has been revised from 780 LF to 1,050 LF
- Bid Item #30 – Hydrant Marker, Type 2B: This bid item has been deleted. Hydrant markers are included in the Raised Pavement Marker, Type 2 bid item.
- Bid Item #39 – Profiled Plastic Line: This quantity has been revised from 25,660 LF to 41,700 LF
- Bid Item #40 – Profiled Plastic Wide Line: This quantity has been revised from 1,650 LF to 1,770 LF
- Bid Item #41 – Plastic Stop Line: This is a new bid item.
- Bid Item #42 – Plastic Crosswalk Line: This is a new bid item.
- Bid Item #43 – Plastic Traffic Arrow: This is a new bid item.
- Bid Item #44 – Plastic Traffic Letter: This is a new bid item.
- Bid Item #45 – Plastic Yield Line Symbol: This is a new bid item.
- Bid Item #41 – Shared Lane Marking: This quantity has been revised from 2 EA

to 0 EA and the bid item has been deleted.

- Bid Item #46 – Temporary Pavement Marking Short Duration: This quantity has been revised from 27,310 LF to 43,470 LF
- Bid Item #47 – Temporary Misc. Pavement Marking – Short Duration: This quantity has been revised from 21 EA to 80 EA
- Bid Item #48– Temporary Stop Line – Short Duration: This is a new bid item.
- Bid Item #49 – Temporary Crosswalk Line – Short Duration: This is a new bid item.
- Bid Item #50 – Resolution of Utility Conflicts: The FA price has been revised from \$3,000 to \$20,000

**(2) Special Provisions Section 8-04.5**

- This section is revised to add the following:

***(May 7, 2026 21ST GSP)***

Section 8-04.4 is supplemented with the following:

Excavation, including haul, is incidental for these structures.

**(3) Special Provisions Section 9-29.3(2)B**

- This section is replaced with the following:

***(May 7, 2026 CFW GSP)***

Section 9-29.3(2)B is supplemented with the following:

Two-conductor through 20-conductor unshielded signal control cable shall have stranded copper conductors.

Multi-conductor cables for vehicle signal heads, pedestrian signal heads, and pedestrian push buttons shall meet IMSA Spec No. 20-1 (P.E. jacket and P.E. insulation) and shall be #14 AWG stranded cable. Multi-conductor cables used to connect the pedestrian signal heads to the pedestrian push buttons shall be 4-conductor, #18 AWG, 600V tray cable, with PVC jacket.

**(4) Special Provisions Section 9-29.19**

- This section is replaced with the following:

***(May 7, 2026 CFW GSP)***

Section 9-29.19 is deleted and replaced with the following:

The Contractor shall provide and install accessible pedestrian push buttons and signs, as shown in the Plans. The position of the pedestrian push buttons shall be located in a manner such that the tactile arrow is aligned parallel to the direction of travel for the crosswalk which the push button is intended to serve; however final positioning for the optimum effectiveness shall be approved by the Engineer.

Accessible pedestrian push button units shall consist of:

- Polara iNS3 Navigator 3-wire accessible pedestrian station, black body, with tactile arrow (part # iNS35TN0-B or approved equal;
- Polara Pedestrian Head Control Unit (part # iPHCU3S) or approved equal;

- Conductor to connect the pedestrian push button and pedestrian signal head, which shall be 4-conductor, #18 AWG, 600V, PVC jacket; and
- Any other labor, materials, or equipment to have a fully-functioning accessible pedestrian push button system at the locations indicated in the Plans.

The station shall meet the following requirements:

Push buttons shall be mounted to the poles by means of stainless steel bolts. All mountings shall be securely fastened as approved by the Engineer.

The sign legend to be used shall be sign designation R10-3e and shall be 9 inches by 15 inches. Sign sheeting shall be engineer grade. All mounting bolts shall be non-corrosive stainless steel.

The pedestrian pushbutton housing shall be aluminum and shall be painted black. Units shall operate at a temperature range of -35C to 85C. Power requirements shall be 120 VAC, 60 Hz (100 ma, typical +/- 20%).

Pedestrian indicators shall include an audible speaker, call confirmation LED, and vibrotactile arrow. The audible speaker shall be programmable to have a button locator tone, acknowledgement tone/message, walk cycle tone/message and clearance tone/message. The units shall have automatic volume controls for message strength over ambient noise levels. The walk tone/message shall be programmable to stop with the walk signal or other user settable time. The units shall be user settable for Accessible Pedestrian Signal (APS) message initiation with an extended press or on call.

The call confirmation LED shall be red with 160 degree view ability and once activated shall remain illuminated until the corresponding walk indication is given. An audible acknowledgement message of "WAIT" shall accompany each activation of the call confirmation LED.

The locator tone shall be active for a time of 0.15 seconds or less and shall repeat at 1 second intervals. The locator tone shall be intensity responsive to ambient sound and be audible from 6 feet to 12 feet from the pushbutton with a maximum of 5 dBA louder than ambient sound.

A walk cycle audible message shall be set for each pushbutton unit indicated in the Plans and shall be patterned after the model: "Broadway. Walk sign is on to cross Broadway." The walk cycle message shall be intensity responsive to ambient sound with a volume 5 dBA above ambient sound up to a maximum volume of 100 dBA. The walk cycle message shall be audible from the beginning of the associated crosswalk during the walk interval only.

The vibrotactile arrow shall be located on the pushbutton and

shall have high visibility contrast of either light on dark or dark on light. The push button units shall be installed in a manner such that the vibrotactile arrow is aligned parallel to the direction of travel for the crosswalk which the push button is intended to serve. The vibrotactile arrow shall activate with the walk cycle.

For RRFB Systems, the accessible pedestrian push button units shall consist of:

- Polara iNX Mid-Block Crossing Push Button Station; green body, with tactile arrow (part # iNX9WN0-G) or approved equal;
- Any other labor, materials, or equipment to have a fully-functioning accessible pedestrian mid-block crossing push button system at the locations indicated in the Plans.

**(5) Special Provisions Section 9-29.20**

- This section is replaced with the following:

***(May 7, 2026 CFW GSP)***

Section 9-29.20 is supplemented with the following:

The symbol message modules shall plug directly into the transformer or be solid-state modules.

Side mountings shall be clamshell mountings Type E, as shown on WSDOT Standard Plans unless otherwise noted in the Plans. All terminal compartments shall be painted in the same manner as specified for signal housings. All pedestrian head mounting bolts shall be noncorrosive stainless steel. Where pedestrian signal heads are to be fastened to the vehicle signal pole, the Contractor shall securely attach the clamshell mounting to the pole using stainless steel Allen-head bolts.

Pedestrian display housings shall have a minimum depth capable of accommodating a Polara Pedestrian Head ControlUnit in the rear of the housing.

Pedestrian signals shall be LED Countdown units as manufactured by Dialight Corporation or approved equal.

All pedestrian signal displays shall be the LED type with displays for "RAISED HAND", "WALKING PERSON" and a countdown timer. Each LED pedestrian signal module shall not require special tools for installation. The installation of an LED pedestrian module shall not require any modification to the housing. Each LED pedestrian module shall be a single, self-contained device, not requiring any on-site assembly for installation into any pedestrian signal housing. The power supply for the LED pedestrian module may be packaged as a separate module.

All pedestrian "RAISED HAND" modules and countdown timer display modules shall be Portland Orange and shall conform to current ITE Standards for size, chromaticity, and intensity. LED pedestrian "RAISED HAND" modules shall be manufactured with

a matrix of AlInGaP LED light sources. All pedestrian "WALKING PERSON" modules shall be Lunar White and shall conform to current ITE Standards for size, chromaticity, and intensity. LED pedestrian "WALKING PERSON" modules shall be manufactured with a matrix of InGaN LED light sources. The "RAISED HAND" and "WALKING PERSON" message-bearing surfaces shall be filled (not outline) symbols. The LED pedestrian modules shall be operationally compatible with controller and conflict monitors on this Project.

The LED pedestrian module shall be rated for use in the ambient operating temperature range of minus 40 degrees C to 74 degrees C. Each LED pedestrian module shall be protected against dust and moisture intrusion in accordance with the NEMA Moisture Resistance STD 250-1991 for Type 4 enclosures to protect all internal components. The assembly, manufacturing, and mounting of the LED pedestrian module shall be designed to assure all internal LED and electronic components are adequately supported to withstand mechanical shock and vibration from high winds and other sources. The manufacturer's name, trademark, serial number, and other necessary identification shall be permanently marked on the backside of the LED pedestrian module. LED signal pedestrian modules used on this Project shall be from the same manufacturer. A label shall be provided on the LED housing, and the Contractor shall mark the label with a permanent marker to note the installation date.

LED pedestrian modules shall operate at a maximum power consumption of 15W. Each LED pedestrian module shall be operated from a 60 plus 3-Hz AC line over a range of 80 VAC to 135 VAC. Nominal operating voltage for all measurements shall be 120 plus 3 volts rms. The LED circuitry shall prevent flicker at less than 100 Hz over the voltage range specified above. Fluctuations in the line voltage specified above shall not affect luminous intensity by more than plus 10 percent. The signal module on-board noise transients and low-repetition high-energy transients shall be as stated in Section 2.1.6, NEMA Standard TS-2, 1992. The individual LED light sources shall be wired so that catastrophic failure of any one LED light source will result in the loss of not more than 20 percent of the signal module light sources. LED pedestrian signal modules shall provide a power factor of 0.90, or greater, when operated at nominal operating voltage, and 25 degrees C. Total harmonic distortion induced into an AC power line by an LED pedestrian module shall not exceed 20 percent. Each LED pedestrian module and associated onboard circuitry shall meet Federal Communications Commission (FCC) Title 47, Subpart B, Section 15 regulations concerning the emission of electrical noise. Two secured, color-coded, 600V, 20AWG minimum, jacketed wires, conforming to the National Electric Code, rated for service at 105 degrees C, are to be provided for electrical connection.

LED signals shall show no evidence of illumination for input voltages below 35 volts. LED signals shall supply illumination

current (unregulated) for all input voltages higher than 45 volts (and conform to appropriate intensity requirements specified above 80 volts).

The manufacturer shall provide a written warranty against defects in materials and workmanship for the LED signal modules for a period of 60 months and against loss of intensity below 50 percent of original values for a period of 36 months after installation of the modules. All warranty documentation shall be given to the Engineer prior to installation.

**C) PLANS**

*DELETE the original sheets and REPLACE with the attached pages which include the following changes:*

**(1) Sheets 12-21, “Roadway and Channelization 1-8 & Intersection Details”**

- The sheets have been revised to add callouts to identify catch basins to be adjusted.
- The sheets have been revised to clarify the electrical work.

**D) BID OPENING**

The Bid Opening Date has been revised to **Tuesday, 12-May-2026 at 2:00pm.**

All bidders are required to acknowledge receipt of this addendum on page RFB-8 of the Bid Form. Failure to do so may cause rejection of the bid.

**CITY OF FEDERAL WAY**

Christine Mullen, P.E.  
Engineering Manager

NOTE: All entries shall be written in ink or typed. Unit prices for all items, all extensions, and total amount of bid shall be shown. Enter unit prices in numerical figures only, in dollars and cents to two (2) decimal places (including for whole dollar amounts). All figures must be clearly legible. Bids with illegible figures in the unit price column will be regarded as nonresponsive. Where conflict occurs between the unit price and the total amount specified for any item, the unit price shall prevail, and totals shall be corrected to conform thereto. The Bidder shall complete this entire Bid Form or this bid may be considered non-responsive. The City may correct obvious mathematical errors. The City of Federal Way reserves the right to reject any and all bids, waive any informalities or minor irregularities in the bidding, and determine which bid or bidder meets the criteria set forth in the bid documents.

<b>SCHEDULE A: ROADWAY IMPROVEMENTS</b>						
<i>All unit prices shall include applicable sales tax (Roadway Improvements)</i>						
<b>Item No.</b>	<b>Spec. Div.</b>	<b>Bid Item Description</b>	<b>Unit</b>	<b>Plan Qty</b>	<b>Unit Price</b>	<b>Amount</b>
1	1-04	MINOR CHANGE	FA	1	\$ 25,000.00	\$ 25,000.00
2	1-05	ROADWAY SURVEYING	LS	1		
3	1-05	ADA FEATURES SURVEYING	LS	1		
4	1-07	SPCC PLAN	LS	1		
5	2-01	MOBILIZATION	LS	1		
6	2-04	TRAFFIC CONTROL SUPERVISOR	LS	1		
7	2-04	PEDESTRIAN TRAFFIC CONTROL	LS	1		
8	2-04	FLAGGERS	HR	2,700		
9	2-04	OTHER TRAFFIC CONTROL LABOR	HR	200		
10	2-04	PORTABLE CHANGEABLE MESSAGE SIGN	HR	1,250		
11	2-04	OTHER TEMPORARY TRAFFIC CONTROL DEVICES	LS	1		
12	2-04	WORK ZONE SAFETY CONTINGENCY	FA	1	\$ 20,000.00	\$ 20,000.00
13	2-04	UNIFORMED POLICE OFFICER	HR	200		
14	3-02	SAWCUTTING	LF	1,550		
15	4-05	CRUSHED SURFACING TOP COURSE	TN	140		
16	5-04	HMA CL. 1/2" PG 58H-22	TN	5,600		
17	5-04	HMA FOR PAVEMENT REPAIR CL. 1/2" PG 59H-22	TN	1,925		
18	5-04	PLANING BITUMINOUS PAVEMENT	SY	40,000		
19	5-04	PAVEMENT REPAIR EXCAVATION, INCL. HAUL	CY	950		

20	7-05	ADJUST CATCH BASIN	EA	15		
21	7-12	ADJUST WATER VALVE TO GRADE	EA	29		
22	7-17	ADJUST SANITARY SEWER MANHOLE	EA	9		
23	8-01	EROSION CONTROL AND WATER POLLUTION PREVENTION	LS	1		
24	8-02	SOD INSTALLATION	SY	56		
25	8-02	PROPERTY RESTORATION	FA	1	\$ 10,000.00	\$ 10,000.00
26	8-04	CEMENT CONC. CURB AND GUTTER	LF	720		
27	8-04	ROLLED CEMENT CONC. TRAFFIC CURB	LF	40		
28	8-04	CEMENT CONC. PEDESTRIAN CURB	LF	50		
29	8-07	CONCRETE PRECAST DUAL SLOPED MOUNTABLE CURB	LF	1,050		
30	8-09	RAISED PAVEMENT MARKER TYPE 2	HUN	13.00		
31	8-13	ADJUST MONUMENT CASE AND COVER	EA	8		
32	8-14	CEMENT CONC. SIDEWALK	SY	40		
33	8-14	CEMENT CONC. CURB RAMP TYPE PARALLEL A	EA	26		
34	8-14	CEMENT CONC. CURB RAMP TYPE PERPENDICULAR	EA	5		
35	8-14	CEMENT CONC. CURB RAMP TYPE SINGLE DIRECTION	EA	7		
36	8-20	SIGNAL MODIFICATION - 21ST AVE SW AND SW 325TH ST	LS	1		
37	8-20	SIGNAL MODIFICATION - 21ST AVE SW AND SW 334TH ST	LS	1		
38	8-20	MODIFICATION - RRFB SYSTEM	EA	3		
39	8-22	PROFILED PLASTIC LINE	LF	41,700		
40	8-22	PROFILED PLASTIC WIDE LINE	LF	1,770		
41	8-22	PLASTIC STOP LINE	LF	320		
42	8-22	PLASTIC CROSSWALK LINE	SF	2,000		
43	8-22	PLASTIC TRAFFIC ARROW	EA	38		
44	8-22	PLASTIC TRAFFIC LETTER	EA	6		
45	8-22	PLASTIC YIELD LINE SYMBOL	EA	36		

46	8-23	TEMPORARY PAVEMENT MARKING - SHORT DURATION	LF	43,470		
47	8-23.	TEMPORARY MISC. PAVEMENT MARKING - SHORT DURATION	EA	80		
48	8-23	TEMPORARY STOP LINE – SHORT DURATION	LF	320		
49	8-23	TEMPORARY CROSSWALK LINE – SHORT DURATION	SF	2,000		
50	8-33	RESOLUTION OF UTILITY CONFLICTS	FA	1	\$ 20,000.00	\$ 20,000.00
<b>TOTAL – SCHEDULE A</b>						<b>\$</b>

<b>BID SUMMARY</b>	
<b>ITEM</b>	<b>BID AMOUNT</b>
<b>SCHEDULE A: ROADWAY IMPROVEMENTS</b>	\$
<b>TOTAL BID AMOUNT</b> <i>(including Washington State sales tax, all other government taxes, assessments and charges)</i>	\$

The documents incorporated by reference, as if fully set forth, are the Advertisement for Bids, the Instructions to Bidders and Checklists, the Contractor’s Bid Proposal (including all forms and supplemental information listed on the Bidders Checklist), the Contract Documents (including Project Plans, Specifications, and all Appendices, Amendments, and Supplemental Reports & Information), the Contract Provisions (including all forms and supplemental information listed on the Contract Checklist), the version of the Washington State Standard Specifications for Road, Bridge, and Municipal Construction identified herein, and any other documents provided to bidders and/or referenced in or referred to by the Contract Documents.

Pursuant to and in compliance with the Advertisement for Bids for the Project, and other documents relating thereto, the undersigned has carefully examined all of the bid and contract documents, considered conditions which may affect the delivery, supply and maintenance for the Project, and hereby proposes to furnish all labor, materials and perform all work as required in strict accordance with the contract documents, for the referenced bid amount, inclusive of Washington State sales tax and all other government taxes, assessments and charges as required by law.

**NON-COLLUSION AFFIDAVIT**

By signing this proposal, the undersigned acknowledges that the person(s), firm, association, or corporation has (have) not, either directly or indirectly, entered into any agreement, participated in any collusion, or otherwise taken any action in restraint of free competitive bidding in connection with this project.

To report rigging activities, call 1-800-424-9071. The U.S. Department of Transportation (USDOT) operates the toll-free hotline Monday through Friday, 8:00 a.m. to 5:00 p.m., Eastern Time. Anyone with knowledge of possible bid rigging, bidder collusion, or other fraudulent activities should use the hotline to report such activities. The hotline is part of USDOT’s continuing effort to identify and investigate highway construction contract fraud and abuse and is operated under the direction of the USDOT Inspector General. All information will be treated confidentially and caller anonymity will be respected.

**CONFLICTS OF INTEREST, GRATUITIES, & NON-COMPETITIVE PRACTICES**

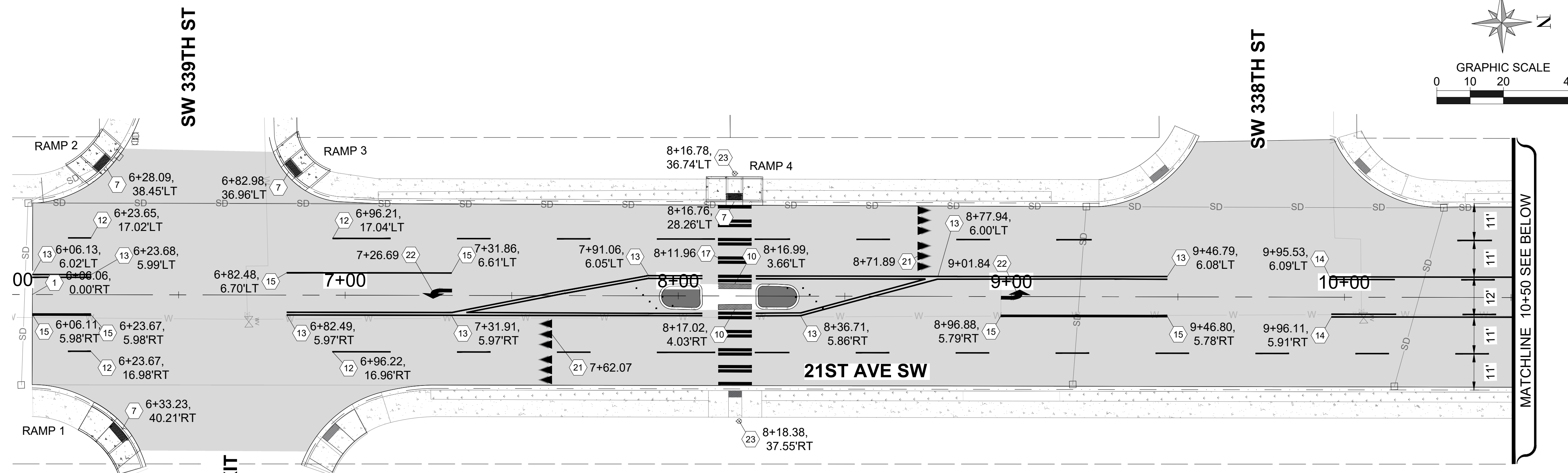

**GENERAL NOTE:**

- CONTRACTOR WILL ADJUST WATER, SEWER, AND CITY UTILITY FACILITIES.
- CONTRACTOR IS RESPONSIBLE TO COORDINATE ADJUSTMENT OF GAS AND TELECOMMUNICATION UTILITIES.

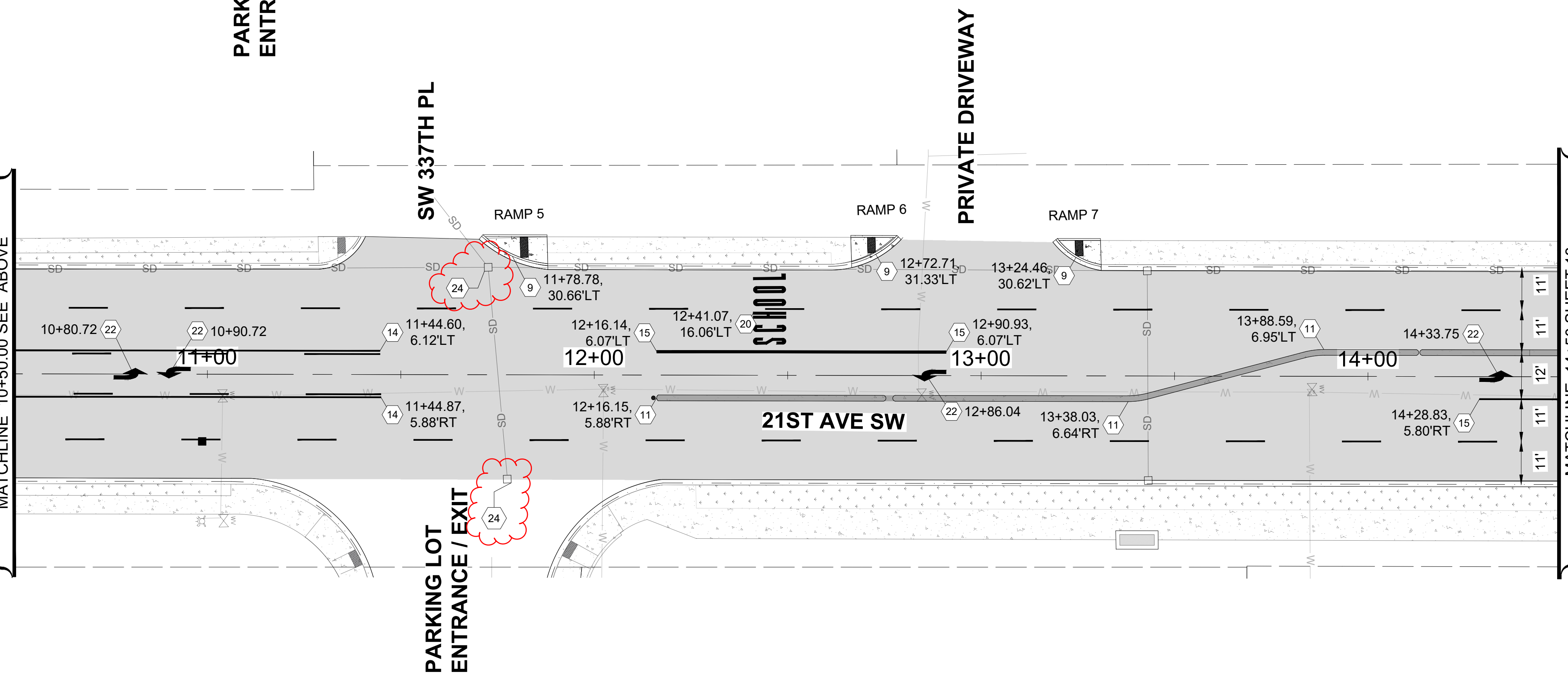

**ROADWAY CONSTRUCTION NOTES:**

- 1 MATCH EXISTING
- 2 CEMENT CONC. ROLLED CURB & GUTTER PER CFW STD. FW.F10.42
- 3 CEMENT CONC. CURB & GUTTER PER CFW STD. FW.F10.42
- 4 CEMENT CONC. PEDESTRIAN CURB PER WSDOT STD.F-10.12-04
- 5 ADJUST MONUMENT CASE & COVER TO GRADE PER CFW STD. DETAIL FW.A10.30-A
- 6 CEMENT CONC. SIDEWALK PER CFW STD. FW.F30.10
- 7 CEMENT CONC. PARALLEL CURB RAMP PER WSDOT STD. PLAN F-40.12-03e
- 8 CEMENT CONC. PERPENDICULAR CURB RAMP PER WSDOT STD. PLAN F-40.15-03e
- 9 CEMENT CONC. SINGLE DIRECTION CURB RAMP PER WSDOT STD. PLAN F-40.16-03e
- 10 DETECTABLE WARNING SURFACE PER WSDOT STD F-45.10-05
- 11 PRECAST DUAL FACED SLOPED MOUNTABLE CURB PER WSDOT STD. F-10.64-03
- 12 PROFILED PLASTIC LANE LINE (MATERIAL TYPE D) PER CFW STD. FW.M20.10
- 13 PROFILED PLASTIC DOUBLE CENTER LINE (MATERIAL TYPE D) PER CFW STD. FW.M20.10
- 14 PROFILED PLASTIC TWO WAY LEFT TURN CENTER LINE (MATERIAL TYPE D) PER CFW STD. FW.M20.10
- 15 PROFILED PLASTIC WIDE LINE (MATERIAL TYPE D) PER CFW STD. FW.M20.10
- 16 PLASTIC STOP LINE (MATERIAL TYPE D) PER CFW STD. FW.M15.10
- 17 PLASTIC CROSSWALK LINE (MATERIAL TYPE D) PER CFW STD. FW.M15.10
- 18 PROFILED PLASTIC WIDE DOTTED LINE (MATERIAL TYPE D) PER CFW STD. FW.M20.10
- 19 PROFILED PLASTIC DOTTED EXTENSION LINE (MATERIAL TYPE D) PER CFW STD. FW.M20.10
- 20 PLASTIC TRAFFIC LETTER PER WSDOT STD. PLAN M-80.10-01e
- 21 PLASTIC YIELD LINE SYMBOL PER CFW STD. FW.M15.10 (MATERIAL TYPE A)
- 22 PLASTIC TRAFFIC ARROW PER CFW STD. FW.M15.10 (MATERIAL TYPE A)
- 23 MODIFICATION - RRFB SYSTEM WITH APS BUTTON ASSEMBLY PER CFW STD. FW J24.20
- 24 ADJUST CATCH BASIN TO GRADE

**LEGEND**

- INSTALL YELLOW TUBULAR MARKER
- ◊ PEDESTRIAN PUSH BUTTON AND POST
- HYDRANT MARKER
- ◐ EXISTING MONUMENT ADJUST CASE & COVER
- △ MONUMENTS IN ISLAND PRESERVE AND PROTECT
- ⊕ MONUMENT TO BE UNCOVERED OR ESTABLISHED
- HMA CL. 1/2" PG58H-22
- ▨ CEMENT CONCRETE SIDEWALK
- ▤ MMA TRUNCATED DOME



33325 8th Avenue South  
Federal Way, WA 98003-6325

(253) 835-2700  
www.federalwaywa.gov

BID SET



DRAFTED: D. MCINTOSH

DESIGNED: C. KINLOCH

REVIEWED: C. MULLEN

APPROVED: D. WINKLER



**DRAWING VERSION / REVISION LOG**

NO.	DATE	REVISION
1	06-MAY-2026	ADDENDUM #2

**21ST AVE SW PRESERVATION**

**ROADWAY & CHANNELIZATION 1**

STA: 6+00-14+50

CITY PROJECT #:

36253

SHT. 12

OF 28

PARKING LOT  
ENTRANCE/EXIT

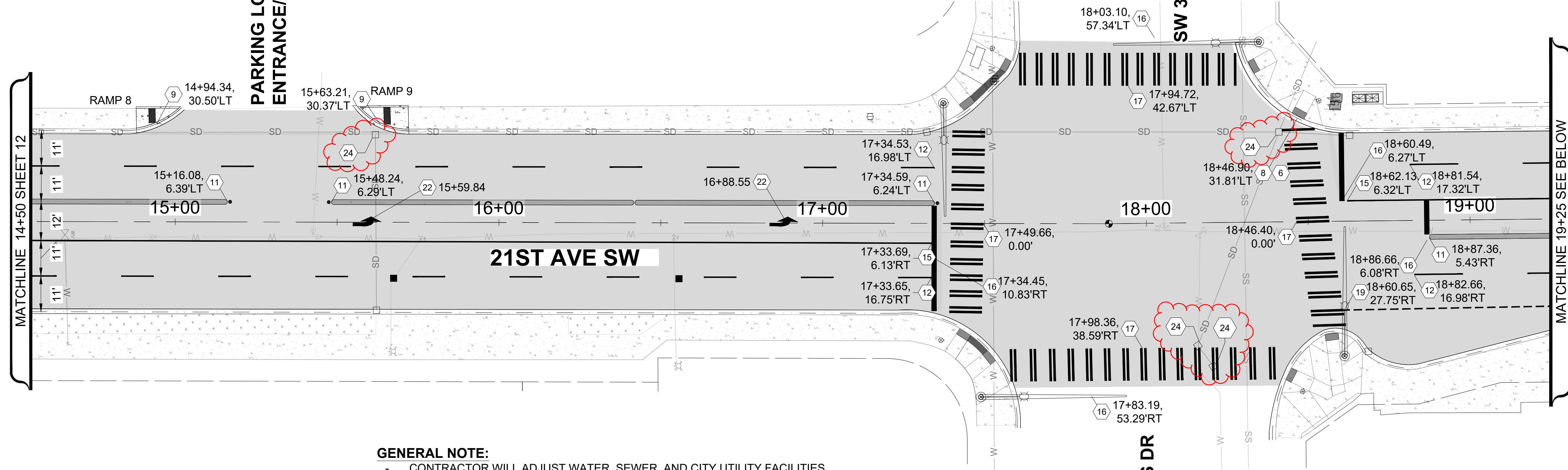

**GENERAL NOTE:**  
 - CONTRACTOR WILL ADJUST WATER, SEWER, AND CITY UTILITY FACILITIES.  
 - CONTRACTOR IS RESPONSIBLE TO COORDINATE ADJUSTMENT OF GAS AND TELECOMMUNICATION UTILITIES.

- ROADWAY CONSTRUCTION NOTES:**
- 1 MATCH EXISTING
  - 2 CEMENT CONC. ROLLED CURB & GUTTER PER CFW STD. FW.F10.42
  - 3 CEMENT CONC. CURB & GUTTER PER CFW STD. FW.F10.42
  - 4 CEMENT CONC. PEDESTRIAN CURB PER WSDOT STD.F-10.12-04
  - 5 ADJUST MONUMENT CASE & COVER TO GRADE PER CFW STD. DETAIL FW.A10.30-A
  - 6 CEMENT CONC. SIDEWALK PER CFW STD. FW.F30.10
  - 7 CEMENT CONC. PARALLEL CURB RAMP PER WSDOT STD. PLAN F-40.12-03e
  - 8 CEMENT CONC. PERPENDICULAR CURB RAMP PER WSDOT STD. PLAN F-40.15-03e
  - 9 CEMENT CONC. SINGLE DIRECTION CURB RAMP PER WSDOT STD. PLAN F-40.16-03e
  - 10 DETECTABLE WARNING SURFACE PER WSDOT STD F-45.10-05
  - 11 PRECAST DUAL FACED SLOPED MOUNTABLE CURB PER WSDOT STD. F-10.64-03
  - 12 PROFILED PLASTIC LANE LINE (MATERIAL TYPE D) PER CFW STD. FW.M20.10
  - 13 PROFILED PLASTIC DOUBLE CENTER LINE (MATERIAL TYPE D) PER CFW STD. FW.M20.10
  - 14 PROFILED PLASTIC TWO WAY LEFT TURN CENTER LINE (MATERIAL TYPE D) PER CFW STD. FW.M20.10
  - 15 PROFILED PLASTIC WIDE LINE (MATERIAL TYPE D) PER CFW STD. FW.M20.10
  - 16 PLASTIC STOP LINE (MATERIAL TYPE D) PER CFW STD. FW.M15.10
  - 17 PLASTIC CROSSWALK LINE (MATERIAL TYPE D) PER CFW STD. FW.M15.10
  - 18 PROFILED PLASTIC WIDE DOTTED LINE (MATERIAL TYPE D) PER CFW STD. FW.M20.10
  - 19 PROFILED PLASTIC DOTTED EXTENSION LINE (MATERIAL TYPE D) PER CFW STD. FW.M20.10
  - 20 PLASTIC TRAFFIC LETTER PER WSDOT STD. PLAN M-80.10-01e
  - 21 PLASTIC YIELD LINE SYMBOL PER CFW STD. FW.M15.10 (MATERIAL TYPE A)
  - 22 PLASTIC TRAFFIC ARROW PER CFW STD. FW.M15.10 (MATERIAL TYPE A)
  - 23 MODIFICATION - RRFB SYSTEM WITH APS BUTTON ASSEMBLY PER CFW STD. FW.J24.20
  - 24 ADJUST CATCH BASIN TO GRADE

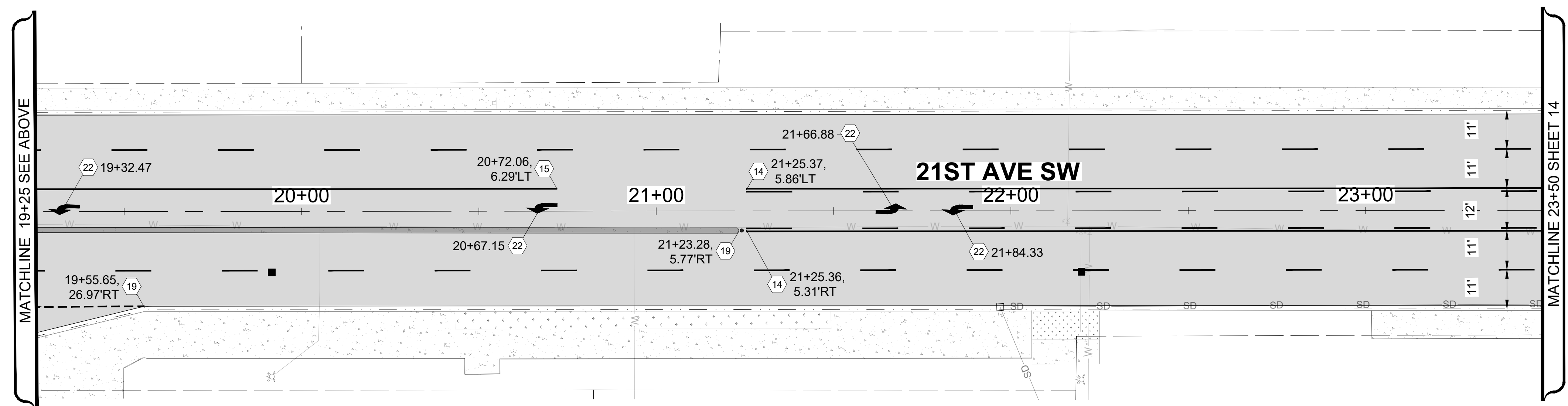

- LEGEND**
- INSTALL YELLOW TUBULAR MARKER
  - ⊕ PEDESTRIAN PUSH BUTTON AND POST
  - HYDRANT MARKER
  - ⚡ EXISTING MONUMENT ADJUST CASE & COVER
  - △ MONUMENTS IN ISLAND PRESERVE AND PROTECT
  - ⊕ MONUMENT TO BE UNCOVERED OR ESTABLISHED
  - HMA CL. 1/2 PG58H-22
  - ▨ CEMENT CONCRETE SIDEWALK
  - ▨ MMA TRUNCATED DOME

**CITY OF Federal Way**  
 Centered on Opportunity  
 33325 8th Avenue South  
 Federal Way, WA 98003-6325  
 (253) 835-2700  
 www.federalwaywa.gov

**BID SET**  
  
 Know what's below.  
 Call 811 before you dig.

DRAFTED: D. MCINTOSH  
 DESIGNED: C. KINLOCH  
 REVIEWED: C. MULLEN  
 APPROVED: D. WINKLER

DRAWING VERSION / REVISION LOG		
NO.	DATE	REVISION
1	06-MAY-2026	ADDENDUM #2

**21ST AVE SW PRESERVATION**  
**ROADWAY & CHANNELIZATION 2**  
 STA: 14+50-23+50

CITY PROJECT #:  
**36253**  
 SHT. 13  
 OF 28

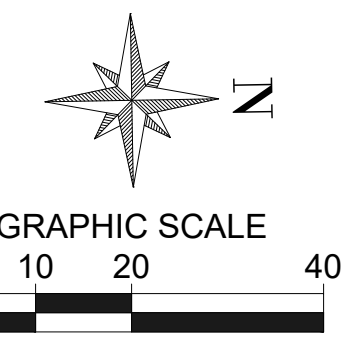
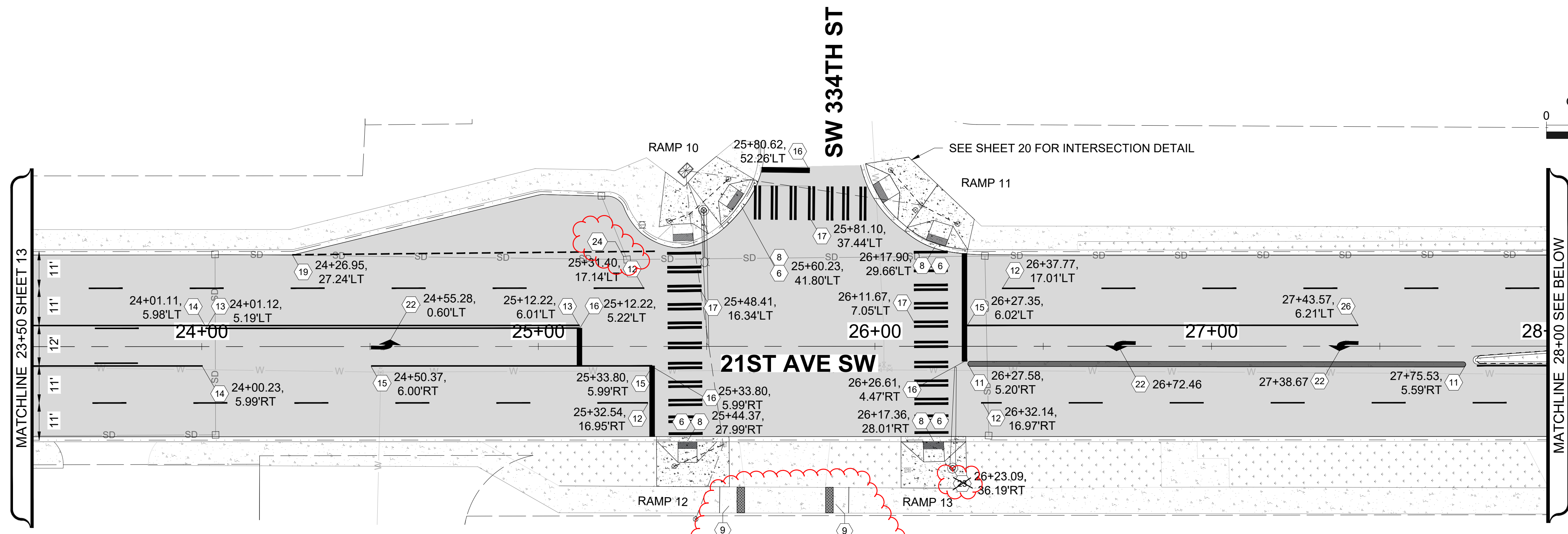

**GENERAL NOTE:**  
 - CONTRACTOR WILL ADJUST WATER, SEWER, AND CITY UTILITY FACILITIES.  
 - CONTRACTOR IS RESPONSIBLE TO COORDINATE ADJUSTMENT OF GAS AND TELECOMMUNICATION UTILITIES.

- ROADWAY CONSTRUCTION NOTES:**
- 1 MATCH EXISTING
  - 2 CEMENT CONC. ROLLED CURB & GUTTER PER CFW STD. FW.F10.42
  - 3 CEMENT CONC. CURB & GUTTER PER CFW STD. FW.F10.42
  - 4 CEMENT CONC. PEDESTRIAN CURB PER WSDOT STD.F-10.12-04
  - 5 ADJUST MONUMENT CASE & COVER TO GRADE PER CFW STD. DETAIL FW.A10.30-A
  - 6 CEMENT CONC. SIDEWALK PER CFW STD. FW.F30.10
  - 7 CEMENT CONC. PARALLEL CURB RAMP PER WSDOT STD. PLAN F-40.12-03e
  - 8 CEMENT CONC. PERPENDICULAR CURB RAMP PER WSDOT STD. PLAN F-40.15-03e
  - 9 CEMENT CONC. SINGLE DIRECTION CURB RAMP PER WSDOT STD. PLAN F-40.16-03e
  - 10 DETECTABLE WARNING SURFACE PER WSDOT STD F-45.10-05
  - 11 PRECAST DUAL FACED SLOPED MOUNTABLE CURB PER WSDOT STD. F-10.64-03
  - 12 PROFILED PLASTIC LANE LINE (MATERIAL TYPE D) PER CFW STD. FW.M20.10
  - 13 PROFILED PLASTIC DOUBLE CENTER LINE (MATERIAL TYPE D) PER CFW STD. FW.M20.10
  - 14 PROFILED PLASTIC TWO WAY LEFT TURN CENTER LINE (MATERIAL TYPE D) PER CFW STD. FW.M20.10
  - 15 PROFILED PLASTIC WIDE LINE (MATERIAL TYPE D) PER CFW STD. FW.M20.10
  - 16 PLASTIC STOP LINE (MATERIAL TYPE D) PER CFW STD. FW.M15.10
  - 17 PLASTIC CROSSWALK LINE (MATERIAL TYPE D) PER CFW STD. FW.M15.10
  - 18 PROFILED PLASTIC WIDE DOTTED LINE (MATERIAL TYPE D) PER CFW STD. FW.M20.10
  - 19 PROFILED PLASTIC DOTTED EXTENSION LINE (MATERIAL TYPE D) PER CFW STD. FW.M20.10
  - 20 PLASTIC TRAFFIC LETTER PER WSDOT STD. PLAN M-80.10-01e
  - 21 PLASTIC YIELD LINE SYMBOL PER CFW STD. FW.M15.10 (MATERIAL TYPE A)
  - 22 PLASTIC TRAFFIC ARROW PER CFW STD. FW.M15.10 (MATERIAL TYPE A)
  - 23 MODIFICATION - RRFB SYSTEM WITH APS BUTTON ASSEMBLY PER CFW STD. FW.J24.20
  - 24 ADJUST CATCH BASIN TO GRADE

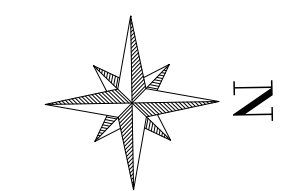
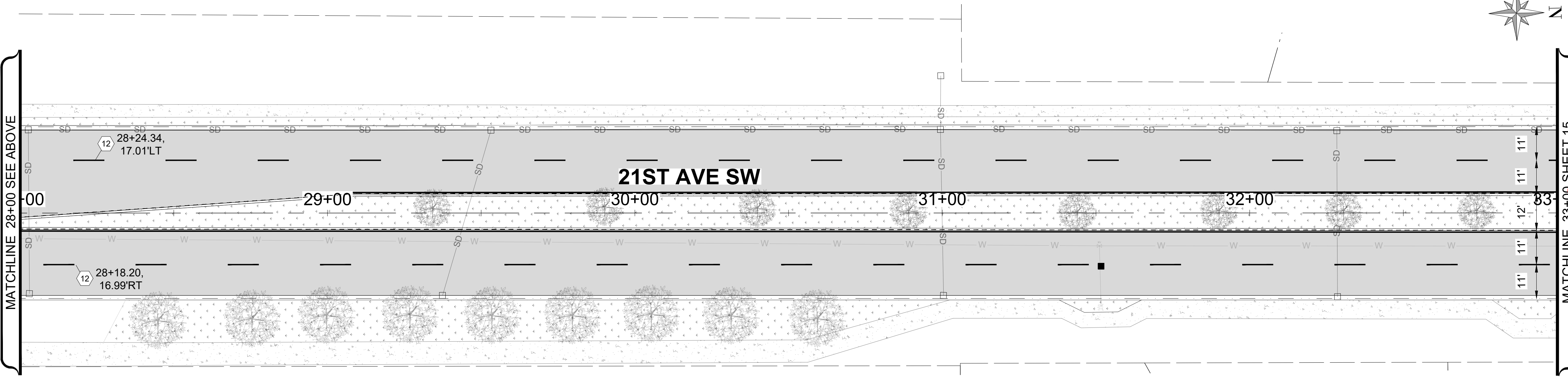

- LEGEND**
- INSTALL YELLOW TUBULAR MARKER
  - ⊕ PEDESTRIAN PUSH BUTTON AND POST
  - HYDRANT MARKER
  - ⚡ EXISTING MONUMENT ADJUST CASE & COVER
  - △ MONUMENTS IN ISLAND PRESERVE AND PROTECT
  - ⊕ MONUMENT TO BE UNCOVERED OR ESTABLISHED
  - HMA CL. 1/2" PG58H-22
  - ▨ CEMENT CONCRETE SIDEWALK
  - ▨ MMA TRUNCATED DOME

**CITY OF Federal Way**  
 Centered on Opportunity  
 33325 8th Avenue South (253) 835-2700  
 Federal Way, WA 98003-6325 www.federalwaywa.gov

**BID SET**  
  
 Know what's below. Call 811 before you dig.

DRAFTED: D. MCINTOSH  
 DESIGNED: C. KINLOCH  
 REVIEWED: C. MULLEN  
 APPROVED: D. WINKLER

DRAWING VERSION / REVISION LOG		
NO.	DATE	REVISION
1	06-MAY-2026	ADDENDUM #2

**21ST AVE SW PRESERVATION**  
**ROADWAY & CHANNELIZATION 3**  
 STA: 23+50-33+00

CITY PROJECT #:  
**36253**  
 SHT. 14  
 OF 28

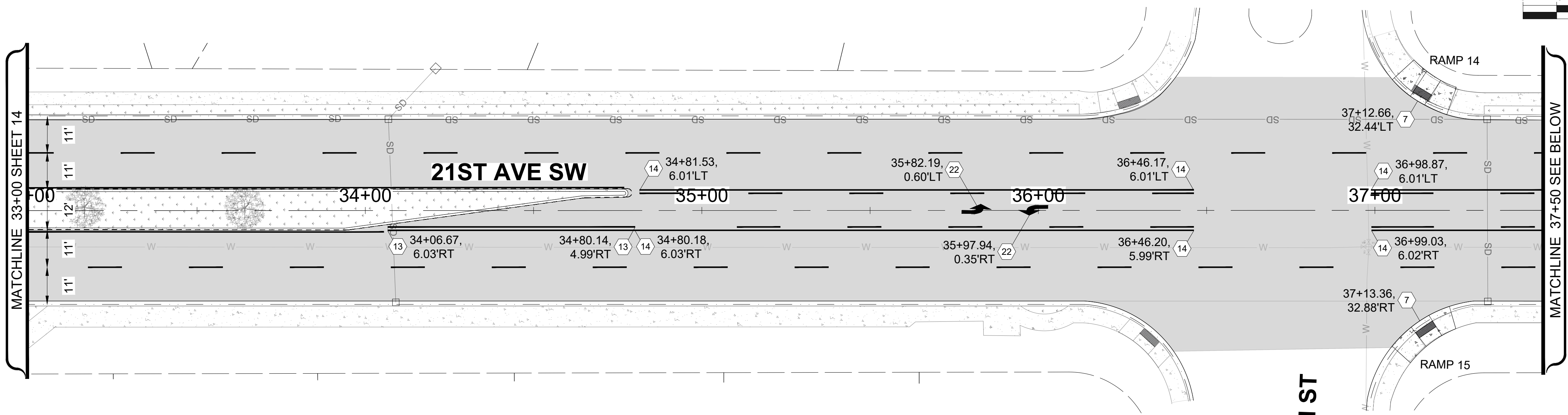
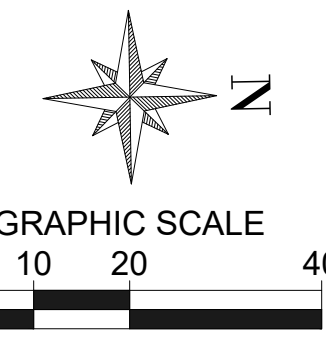

**GENERAL NOTE:**  
 - CONTRACTOR WILL ADJUST WATER, SEWER, AND CITY UTILITY FACILITIES.  
 - CONTRACTOR IS RESPONSIBLE TO COORDINATE ADJUSTMENT OF GAS AND TELECOMMUNICATION UTILITIES.

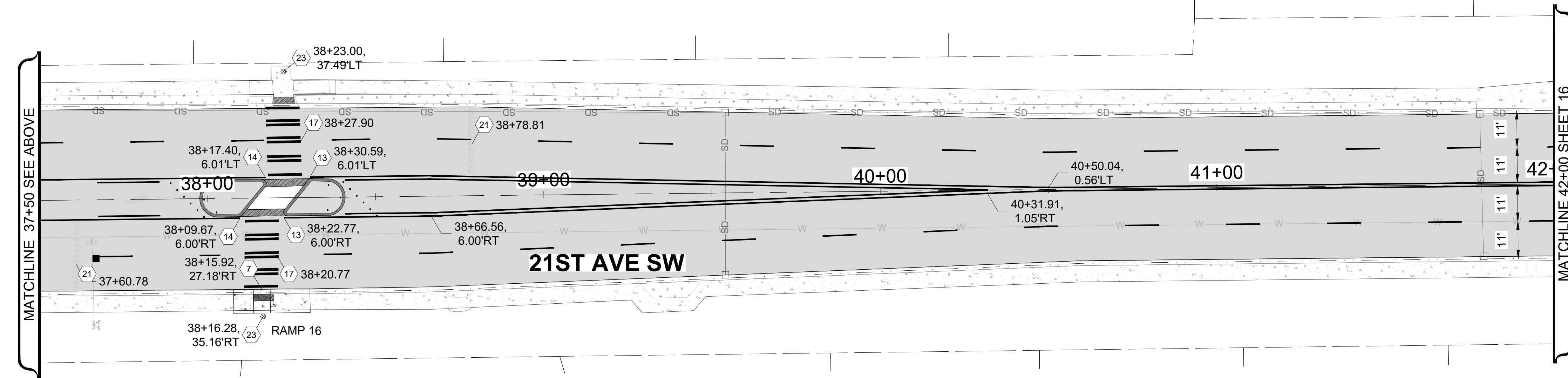

- ROADWAY CONSTRUCTION NOTES:**
- 1 MATCH EXISTING
  - 2 CEMENT CONC. ROLLED CURB & GUTTER PER CFW STD. FW.F10.42
  - 3 CEMENT CONC. CURB & GUTTER PER CFW STD. FW.F10.42
  - 4 CEMENT CONC. PEDESTRIAN CURB PER WSDOT STD.F-10.12-04
  - 5 ADJUST MONUMENT CASE & COVER TO GRADE PER CFW STD. DETAIL FW.A10.30-A
  - 6 CEMENT CONC. SIDEWALK PER CFW STD. FW.F30.10
  - 7 CEMENT CONC. PARALLEL CURB RAMP PER WSDOT STD. PLAN F-40.12-03e
  - 8 CEMENT CONC. PERPENDICULAR CURB RAMP PER WSDOT STD. PLAN F-40.15-03e
  - 9 CEMENT CONC. SINGLE DIRECTION CURB RAMP PER WSDOT STD. PLAN F-40.16-03e
  - 10 DETECTABLE WARNING SURFACE PER WSDOT STD F-45.10-05
  - 11 PRECAST DUAL FACED SLOPED MOUNTABLE CURB PER WSDOT STD. F-10.64-03
  - 12 PROFILED PLASTIC LANE LINE (MATERIAL TYPE D) PER CFW STD. FW.M20.10
  - 13 PROFILED PLASTIC DOUBLE CENTER LINE (MATERIAL TYPE D) PER CFW STD. FW.M20.10
  - 14 PROFILED PLASTIC TWO WAY LEFT TURN CENTER LINE (MATERIAL TYPE D) PER CFW STD. FW.M20.10
  - 15 PROFILED PLASTIC WIDE LINE (MATERIAL TYPE D) PER CFW STD. FW.M20.10
  - 16 PLASTIC STOP LINE (MATERIAL TYPE D) PER CFW STD. FW.M15.10
  - 17 PLASTIC CROSSWALK LINE (MATERIAL TYPE D) PER CFW STD. FW.M15.10
  - 18 PROFILED PLASTIC WIDE DOTTED LINE (MATERIAL TYPE D) PER CFW STD. FW.M20.10
  - 19 PROFILED PLASTIC DOTTED EXTENSION LINE (MATERIAL TYPE D) PER CFW STD. FW.M20.10
  - 20 PLASTIC TRAFFIC LETTER PER WSDOT STD. PLAN M-80.10-01e
  - 21 PLASTIC YIELD LINE SYMBOL PER CFW STD. FW.M15.10 (MATERIAL TYPE A)
  - 22 PLASTIC TRAFFIC ARROW PER CFW STD. FW.M15.10 (MATERIAL TYPE A)
  - 23 MODIFICATION - RRFB SYSTEM WITH APS BUTTON ASSEMBLY PER CFW STD. FW.J24.20
  - 24 ADJUST CATCH BASIN TO GRADE

- LEGEND**
- INSTALL YELLOW TUBULAR MARKER
  - ⊕ PEDESTRIAN PUSH BUTTON AND POST
  - HYDRANT MARKER
  - ⚡ EXISTING MONUMENT ADJUST CASE & COVER
  - △ MONUMENTS IN ISLAND PRESERVE AND PROTECT
  - ⊕ MONUMENT TO BE UNCOVERED OR ESTABLISHED
  - HMA CL. 1/2" PG58H-22
  - ▨ CEMENT CONCRETE SIDEWALK
  - ▨ MMA TRUNCATED DOME

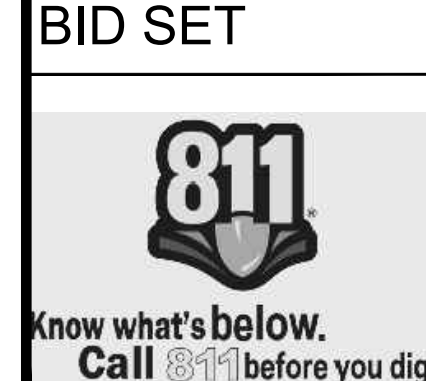

DRAFTED: D. MCINTOSH  
 DESIGNED: C. KINLOCH  
 REVIEWED: C. MULLEN  
 APPROVED: D. WINKLER



DRAWING VERSION / REVISION LOG		
NO.	DATE	REVISION
1	06-MAY-2026	ADDENDUM #2

**21ST AVE SW PRESERVATION**  
**ROADWAY & CHANNELIZATION 4**  
 STA: 37+00-42+00

CITY PROJECT #:  
**36253**  
 SHT. 15  
 OF 28

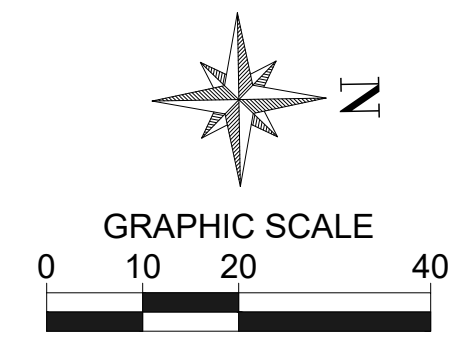
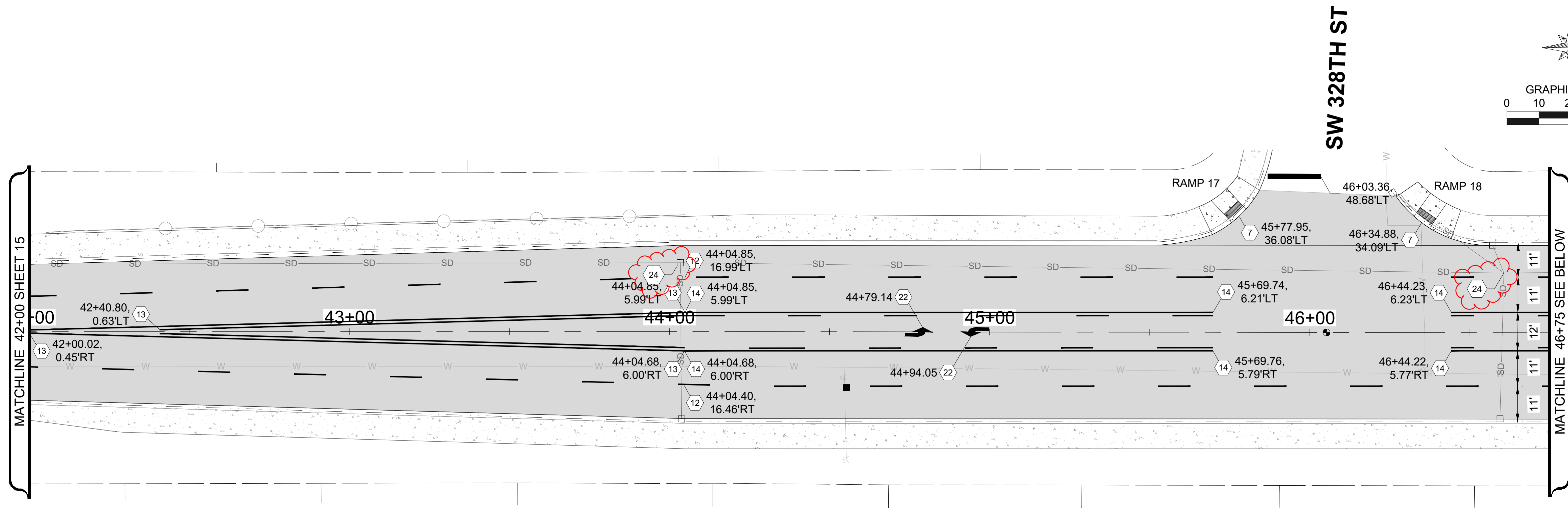

- ROADWAY CONSTRUCTION NOTES:**
- 1 MATCH EXISTING
  - 2 CEMENT CONC. ROLLED CURB & GUTTER PER CFW STD. FW.F10.42
  - 3 CEMENT CONC. CURB & GUTTER PER CFW STD. FW.F10.42
  - 4 CEMENT CONC. PEDESTRIAN CURB PER WSDOT STD.F-10.12-04
  - 5 ADJUST MONUMENT CASE & COVER TO GRADE PER CFW STD. DETAIL FW.A10.30-A
  - 6 CEMENT CONC. SIDEWALK PER CFW STD. FW.F30.10
  - 7 CEMENT CONC. PARALLEL CURB RAMP PER WSDOT STD. PLAN F-40.12-03e
  - 8 CEMENT CONC. PERPENDICULAR CURB RAMP PER WSDOT STD. PLAN F-40.15-03e
  - 9 CEMENT CONC. SINGLE DIRECTION CURB RAMP PER WSDOT STD. PLAN F-40.16-03e
  - 10 DETECTABLE WARNING SURFACE PER WSDOT STD F-45.10-05
  - 11 PRECAST DUAL FACED SLOPED MOUNTABLE CURB PER WSDOT STD. F-10.64-03
  - 12 PROFILED PLASTIC LANE LINE (MATERIAL TYPE D) PER CFW STD. FW.M20.10
  - 13 PROFILED PLASTIC DOUBLE CENTER LINE (MATERIAL TYPE D) PER CFW STD. FW.M20.10
  - 14 PROFILED PLASTIC TWO WAY LEFT TURN CENTER LINE (MATERIAL TYPE D) PER CFW STD. FW.M20.10
  - 15 PROFILED PLASTIC WIDE LINE (MATERIAL TYPE D) PER CFW STD. FW.M20.10
  - 16 PLASTIC STOP LINE (MATERIAL TYPE D) PER CFW STD. FW.M15.10
  - 17 PLASTIC CROSSWALK LINE (MATERIAL TYPE D) PER CFW STD. FW.M15.10
  - 18 PROFILED PLASTIC WIDE DOTTED LINE (MATERIAL TYPE D) PER CFW STD. FW.M20.10
  - 19 PROFILED PLASTIC DOTTED EXTENSION LINE (MATERIAL TYPE D) PER CFW STD. FW.M20.10
  - 20 PLASTIC TRAFFIC LETTER PER WSDOT STD. PLAN M-80.10-01e
  - 21 PLASTIC YIELD LINE SYMBOL PER CFW STD. FW.M15.10 (MATERIAL TYPE A)
  - 22 PLASTIC TRAFFIC ARROW PER CFW STD. FW.M15.10 (MATERIAL TYPE A)
  - 23 MODIFICATION - RRFB SYSTEM WITH APS BUTTON ASSEMBLY PER CFW STD. FW.J24.20
  - 24 ADJUST CATCH BASIN TO GRADE

**GENERAL NOTE:**

- CONTRACTOR WILL ADJUST WATER, SEWER, AND CITY UTILITY FACILITIES.
- CONTRACTOR IS RESPONSIBLE TO COORDINATE ADJUSTMENT OF GAS AND TELECOMMUNICATION UTILITIES.

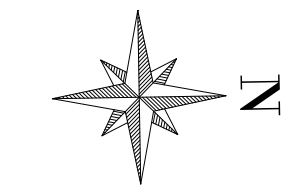
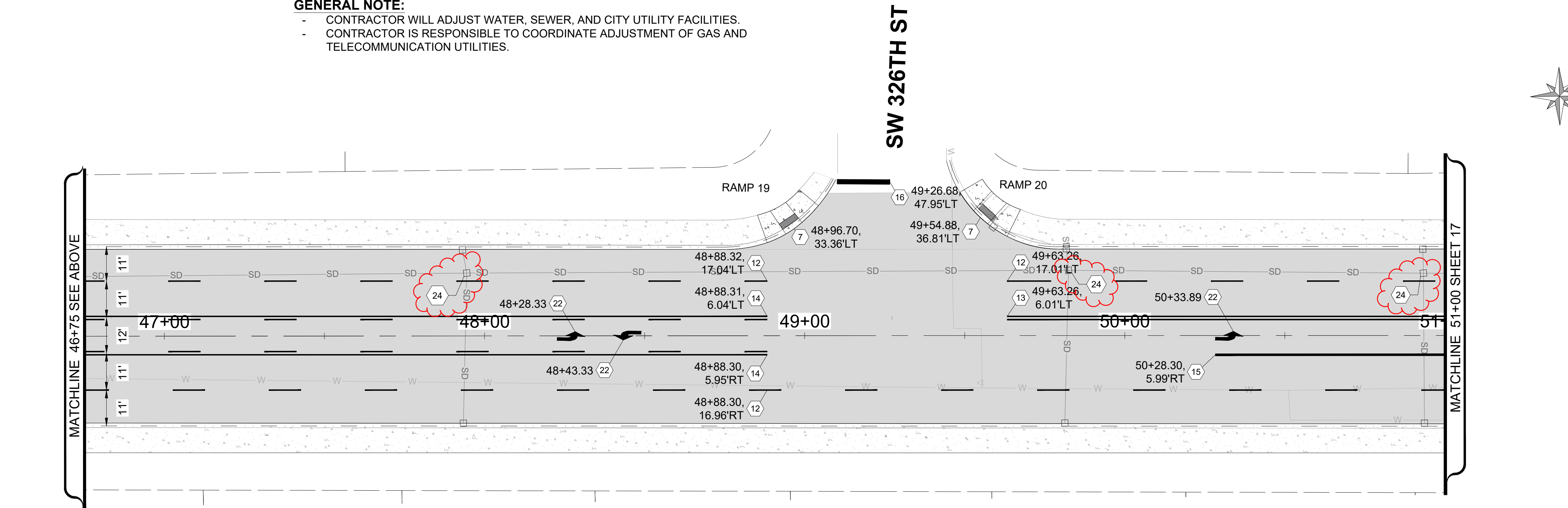

- LEGEND**
- INSTALL YELLOW TUBULAR MARKER
  - ⊕ PEDESTRIAN PUSH BUTTON AND POST
  - HYDRANT MARKER
  - ⚡ EXISTING MONUMENT ADJUST CASE & COVER
  - △ MONUMENTS IN ISLAND PRESERVE AND PROTECT
  - ⊕ MONUMENT TO BE UNCOVERED OR ESTABLISHED
  - HMA CL. 1/2" PG58H-22
  - ▨ CEMENT CONCRETE SIDEWALK
  - ▨ MMA TRUNCATED DOME

**CITY OF Federal Way**  
Centered on Opportunity

33325 8th Avenue South  
Federal Way, WA 98003-6325

(253) 835-2700  
www.federalwaywa.gov

BID SET

know what's below.  
Call 811 before you dig.

DRAFTED: D. MCINTOSH  
DESIGNED: C. KINLOCH  
REVIEWED: C. MULLEN  
APPROVED: D. WINKLER

17-Apr-2026

DRAWING VERSION / REVISION LOG		
NO.	DATE	REVISION
1	06-MAY-2026	ADDENDUM #2

**21ST AVE SW PRESERVATION**

**ROADWAY & CHANNELIZATION 5**

STA: 42+00-51+50

CITY PROJECT #:  
**36253**

SHT. 16  
OF 28

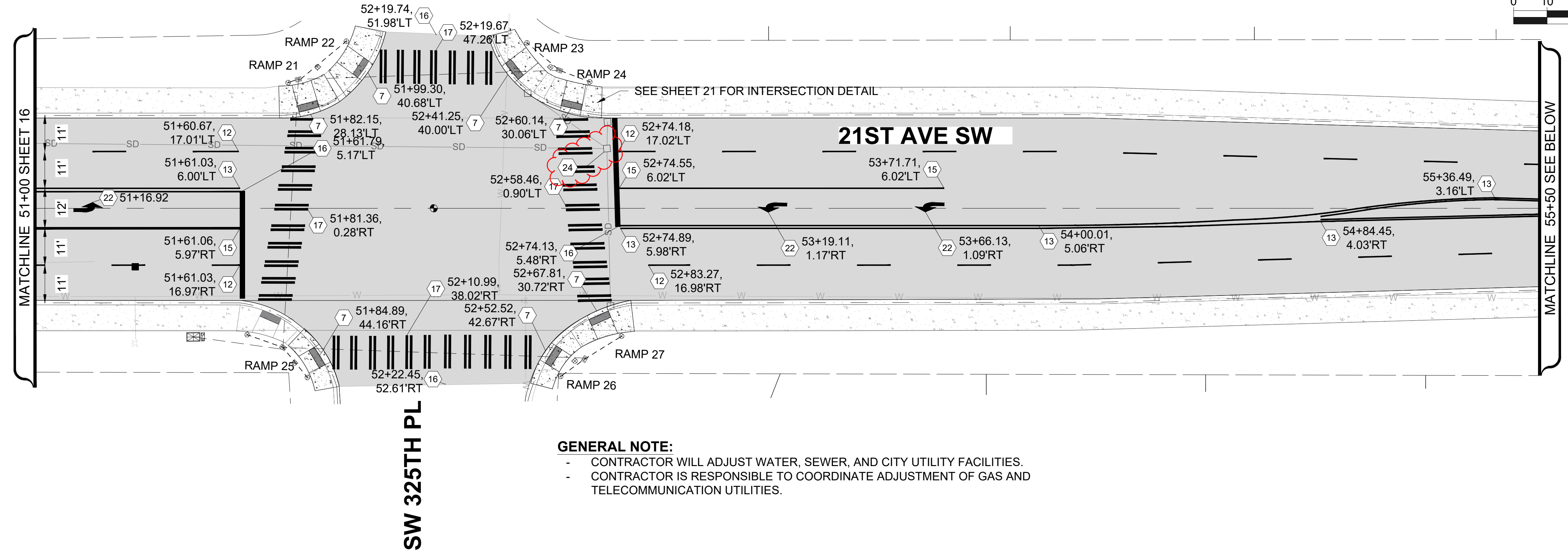
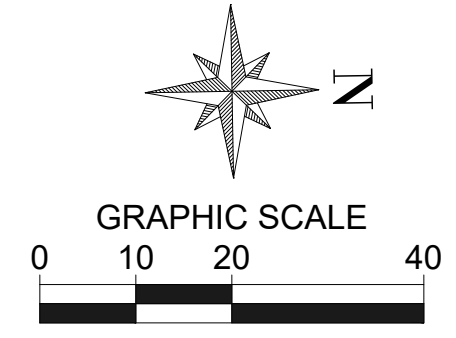

**GENERAL NOTE:**  
 - CONTRACTOR WILL ADJUST WATER, SEWER, AND CITY UTILITY FACILITIES.  
 - CONTRACTOR IS RESPONSIBLE TO COORDINATE ADJUSTMENT OF GAS AND TELECOMMUNICATION UTILITIES.

- ROADWAY CONSTRUCTION NOTES:**
- 1 MATCH EXISTING
  - 2 CEMENT CONC. ROLLED CURB & GUTTER PER CFW STD. FW.F10.42
  - 3 CEMENT CONC. CURB & GUTTER PER CFW STD. FW.F10.42
  - 4 CEMENT CONC. PEDESTRIAN CURB PER WSDOT STD.F-10.12-04
  - 5 ADJUST MONUMENT CASE & COVER TO GRADE PER CFW STD. DETAIL FW.A10.30-A
  - 6 CEMENT CONC. SIDEWALK PER CFW STD. FW.F30.10
  - 7 CEMENT CONC. PARALLEL CURB RAMP PER WSDOT STD. PLAN F-40.12-03e
  - 8 CEMENT CONC. PERPENDICULAR CURB RAMP PER WSDOT STD. PLAN F-40.15-03e
  - 9 CEMENT CONC. SINGLE DIRECTION CURB RAMP PER WSDOT STD. PLAN F-40.16-03e
  - 10 DETECTABLE WARNING SURFACE PER WSDOT STD F-45.10-05
  - 11 PRECAST DUAL FACED SLOPED MOUNTABLE CURB PER WSDOT STD. F-10.64-03
  - 12 PROFILED PLASTIC LANE LINE (MATERIAL TYPE D) PER CFW STD. FW.M20.10
  - 13 PROFILED PLASTIC DOUBLE CENTER LINE (MATERIAL TYPE D) PER CFW STD. FW.M20.10
  - 14 PROFILED PLASTIC TWO WAY LEFT TURN CENTER LINE (MATERIAL TYPE D) PER CFW STD. FW.M20.10
  - 15 PROFILED PLASTIC WIDE LINE (MATERIAL TYPE D) PER CFW STD. FW.M20.10
  - 16 PLASTIC STOP LINE (MATERIAL TYPE D) PER CFW STD. FW.M15.10
  - 17 PLASTIC CROSSWALK LINE (MATERIAL TYPE D) PER CFW STD. FW.M15.10
  - 18 PROFILED PLASTIC WIDE DOTTED LINE (MATERIAL TYPE D) PER CFW STD. FW.M20.10
  - 19 PROFILED PLASTIC DOTTED EXTENSION LINE (MATERIAL TYPE D) PER CFW STD. FW.M20.10
  - 20 PLASTIC TRAFFIC LETTER PER WSDOT STD. PLAN M-80.10-01e
  - 21 PLASTIC YIELD LINE SYMBOL PER CFW STD. FW.M15.10 (MATERIAL TYPE A)
  - 22 PLASTIC TRAFFIC ARROW PER CFW STD. FW.M15.10 (MATERIAL TYPE A)
  - 23 MODIFICATION - RRFB SYSTEM WITH APS BUTTON ASSEMBLY PER CFW STD. FW.J24.20
  - 24 ADJUST CATCH BASIN TO GRADE

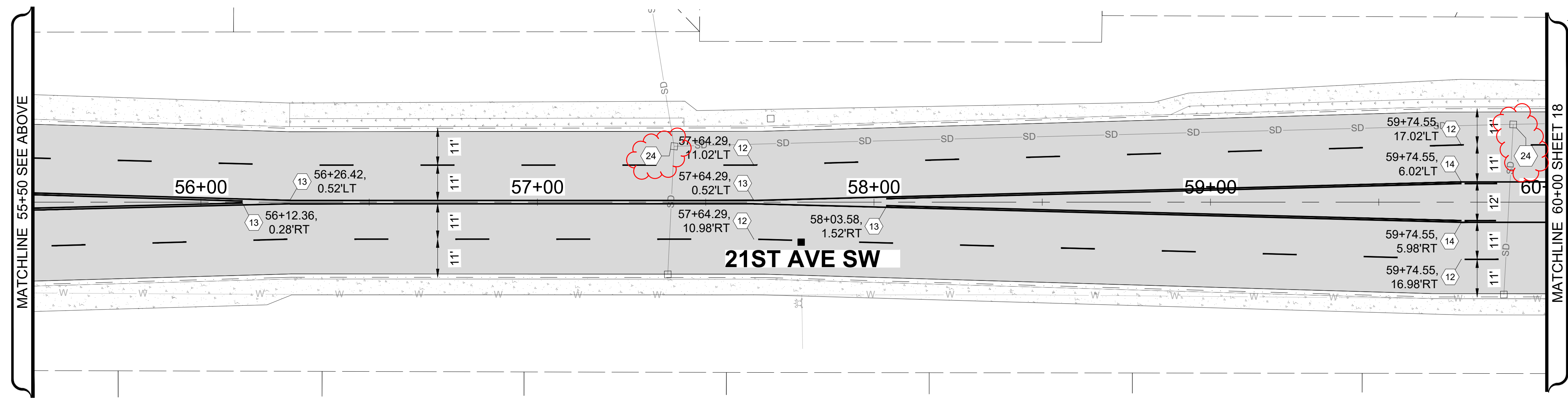

- LEGEND**
- INSTALL YELLOW TUBULAR MARKER
  - ◊ PEDESTRIAN PUSH BUTTON AND POST
  - HYDRANT MARKER
  - ⚡ EXISTING MONUMENT ADJUST CASE & COVER
  - △ MONUMENTS IN ISLAND PRESERVE AND PROTECT
  - ⊕ MONUMENT TO BE UNCOVERED OR ESTABLISHED
  - HMA CL. 1/2 PG58H-22
  - ▨ CEMENT CONCRETE SIDEWALK
  - ▨ MMA TRUNCATED DOME

**CITY OF Federal Way**  
 Centered on Opportunity  
 33325 8th Avenue South (253) 835-2700  
 Federal Way, WA 98003-6325 www.federalwaywa.gov

**BID SET**  
  
 Know what's below.  
 Call 811 before you dig.

DRAFTED: D. MCINTOSH  
 DESIGNED: C. KINLOCH  
 REVIEWED: C. MULLEN  
 APPROVED: D. WINKLER

DRAWING VERSION / REVISION LOG		
NO.	DATE	REVISION
1	06-MAY-2026	ADDENDUM #2

**21ST AVE SW PRESERVATION**  
**ROADWAY & CHANNELIZATION 6**  
 STA: 51+50 - 60+50

CITY PROJECT #:  
**36253**  
 SHT. 17  
 OF 28

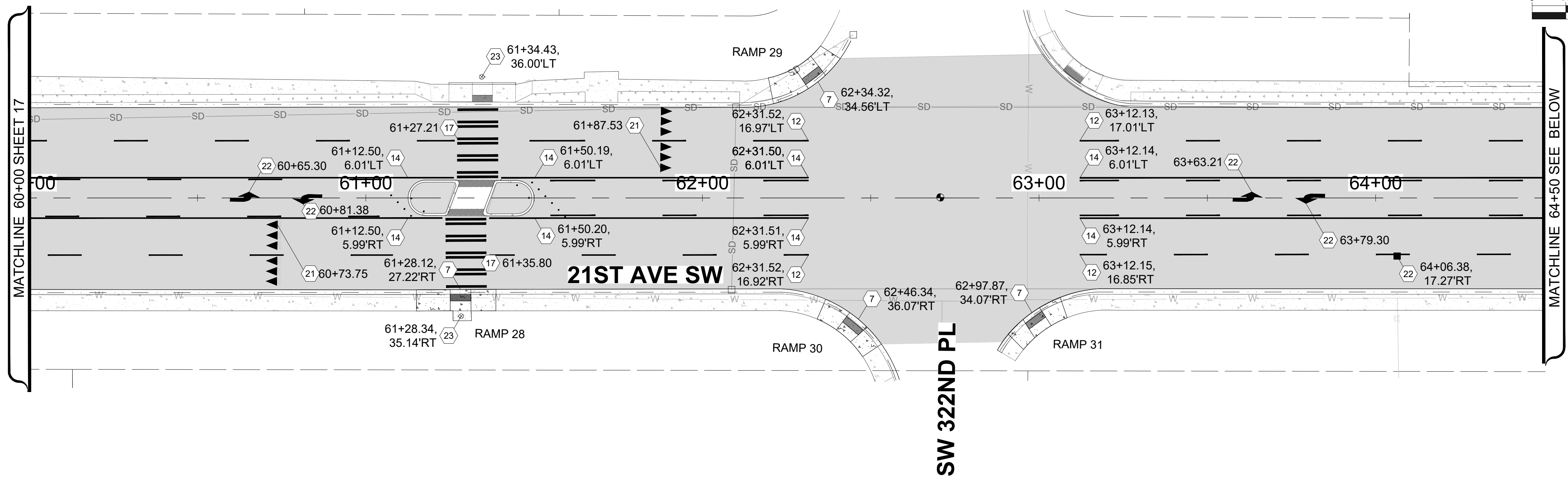
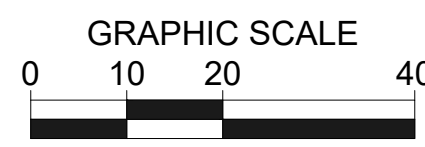
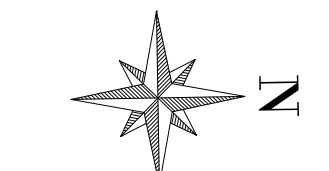

- ROADWAY CONSTRUCTION NOTES:**
- 1 MATCH EXISTING
  - 2 CEMENT CONC. ROLLED CURB & GUTTER PER CFW STD. FW.F10.42
  - 3 CEMENT CONC. CURB & GUTTER PER CFW STD. FW.F10.42
  - 4 CEMENT CONC. PEDESTRIAN CURB PER WSDOT STD.F-10.12-04
  - 5 ADJUST MONUMENT CASE & COVER TO GRADE PER CFW STD. DETAIL FW.A10.30-A
  - 6 CEMENT CONC. SIDEWALK PER CFW STD. FW.F30.10
  - 7 CEMENT CONC. PARALLEL CURB RAMP PER WSDOT STD. PLAN F-40.12-03e
  - 8 CEMENT CONC. PERPENDICULAR CURB RAMP PER WSDOT STD. PLAN F-40.15-03e
  - 9 CEMENT CONC. SINGLE DIRECTION CURB RAMP PER WSDOT STD. PLAN F-40.16-03e
  - 10 DETECTABLE WARNING SURFACE PER WSDOT STD F-45.10-05
  - 11 PRECAST DUAL FACED SLOPED MOUNTABLE CURB PER WSDOT STD. F-10.64-03
  - 12 PROFILED PLASTIC LANE LINE (MATERIAL TYPE D) PER CFW STD. FW.M20.10
  - 13 PROFILED PLASTIC DOUBLE CENTER LINE (MATERIAL TYPE D) PER CFW STD. FW.M20.10
  - 14 PROFILED PLASTIC TWO WAY LEFT TURN CENTER LINE (MATERIAL TYPE D) PER CFW STD. FW.M20.10
  - 15 PROFILED PLASTIC WIDE LINE (MATERIAL TYPE D) PER CFW STD. FW.M20.10
  - 16 PLASTIC STOP LINE (MATERIAL TYPE D) PER CFW STD. FW.M15.10
  - 17 PLASTIC CROSSWALK LINE (MATERIAL TYPE D) PER CFW STD. FW.M15.10
  - 18 PROFILED PLASTIC WIDE DOTTED LINE (MATERIAL TYPE D) PER CFW STD. FW.M20.10
  - 19 PROFILED PLASTIC DOTTED EXTENSION LINE (MATERIAL TYPE D) PER CFW STD. FW.M20.10
  - 20 PLASTIC TRAFFIC LETTER PER WSDOT STD. PLAN M-80.10-01e
  - 21 PLASTIC YIELD LINE SYMBOL PER CFW STD. FW.M15.10 (MATERIAL TYPE A)
  - 22 PLASTIC TRAFFIC ARROW PER CFW STD. FW.M15.10 (MATERIAL TYPE A)
  - 23 MODIFICATION - RRFB SYSTEM WITH APS BUTTON ASSEMBLY PER CFW STD. FW.J24.20
  - 24 ADJUST CATCH BASIN TO GRADE

**GENERAL NOTE:**

- CONTRACTOR WILL ADJUST WATER, SEWER, AND CITY UTILITY FACILITIES.
- CONTRACTOR IS RESPONSIBLE TO COORDINATE ADJUSTMENT OF GAS AND TELECOMMUNICATION UTILITIES.

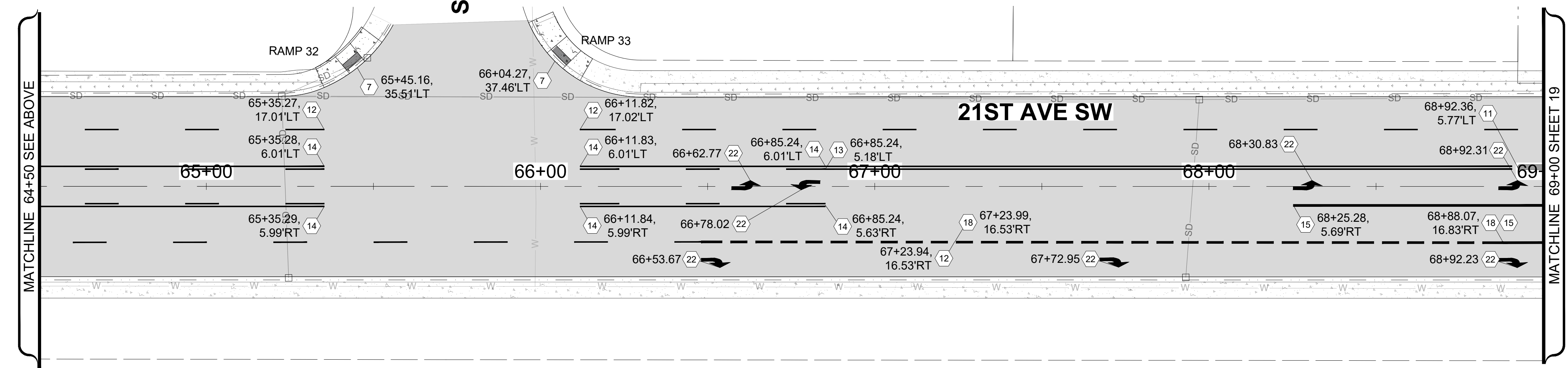
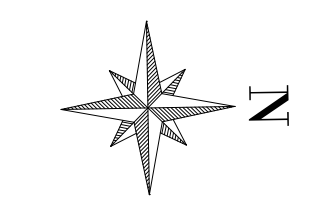

- LEGEND**
- INSTALL YELLOW TUBULAR MARKER
  - ⊕ PEDESTRIAN PUSH BUTTON AND POST
  - HYDRANT MARKER
  - ⚡ EXISTING MONUMENT ADJUST CASE & COVER
  - △ MONUMENTS IN ISLAND PRESERVE AND PROTECT
  - ⊕ MONUMENT TO BE UNCOVERED OR ESTABLISHED
  - HMA CL. 1/2" PG58H-22
  - ▨ CEMENT CONCRETE SIDEWALK
  - ▨ MMA TRUNCATED DOME

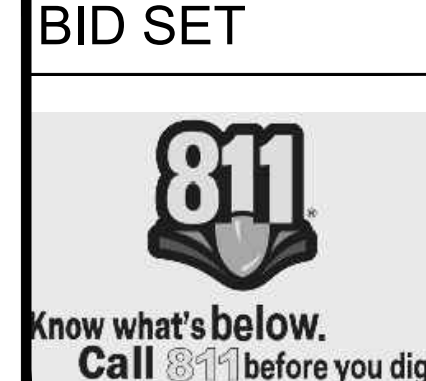

DRAFTED: D. MCINTOSH  
 DESIGNED: C. KINLOCH  
 REVIEWED: C. MULLEN  
 APPROVED: D. WINKLER



DRAWING VERSION / REVISION LOG		
NO.	DATE	REVISION
1	06-MAY-2026	ADDENDUM #2

**21ST AVE SW PRESERVATION**  
**ROADWAY & CHANNELIZATION 7**  
 STA: 60+50 - 69+50

CITY PROJECT #:  
**36253**  
 SHT. 18  
 OF 28

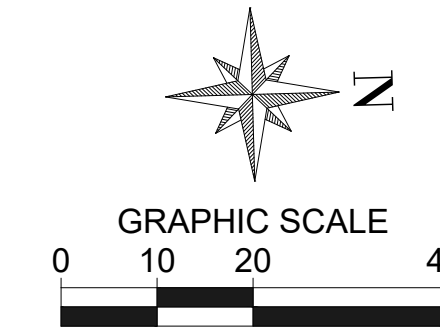
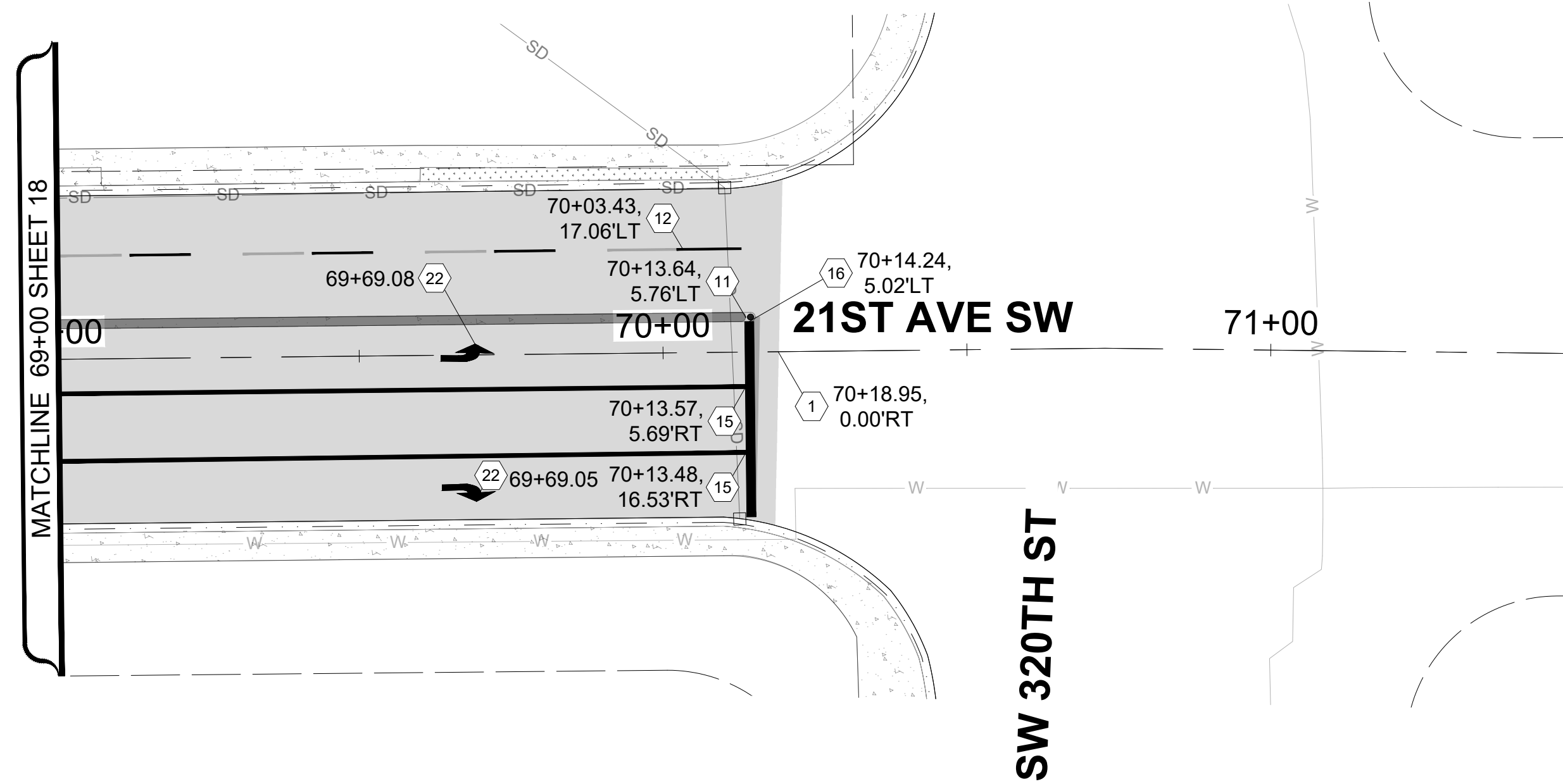

**GENERAL NOTE:**

- CONTRACTOR WILL ADJUST WATER, SEWER, AND CITY UTILITY FACILITIES.
- CONTRACTOR IS RESPONSIBLE TO COORDINATE ADJUSTMENT OF GAS AND TELECOMMUNICATION UTILITIES.

**ROADWAY CONSTRUCTION NOTES:**

- 1 MATCH EXISTING
- 2 CEMENT CONC. ROLLED CURB & GUTTER PER CFW STD. FW.F10.42
- 3 CEMENT CONC. CURB & GUTTER PER CFW STD. FW.F10.42
- 4 CEMENT CONC. PEDESTRIAN CURB PER WSDOT STD.F-10.12-04
- 5 ADJUST MONUMENT CASE & COVER TO GRADE PER CFW STD. DETAIL FW.A10.30-A
- 6 CEMENT CONC. SIDEWALK PER CFW STD. FW.F30.10
- 7 CEMENT CONC. PARALLEL CURB RAMP PER WSDOT STD. PLAN F-40.12-03e
- 8 CEMENT CONC. PERPENDICULAR CURB RAMP PER WSDOT STD. PLAN F-40.15-03e
- 9 CEMENT CONC. SINGLE DIRECTION CURB RAMP PER WSDOT STD. PLAN F-40.16-03e
- 10 DETECTABLE WARNING SURFACE PER WSDOT STD F-45.10-05
- 11 PRECAST DUAL FACED SLOPED MOUNTABLE CURB PER WSDOT STD. F-10.64-03
- 12 PROFILED PLASTIC LANE LINE (MATERIAL TYPE D) PER CFW STD. FW.M20.10
- 13 PROFILED PLASTIC DOUBLE CENTER LINE (MATERIAL TYPE D) PER CFW STD. FW.M20.10
- 14 PROFILED PLASTIC TWO WAY LEFT TURN CENTER LINE (MATERIAL TYPE D) PER CFW STD. FW.M20.10
- 15 PROFILED PLASTIC WIDE LINE (MATERIAL TYPE D) PER CFW STD. FW.M20.10
- 16 PLASTIC STOP LINE (MATERIAL TYPE D) PER CFW STD. FW.M15.10
- 17 PLASTIC CROSSWALK LINE (MATERIAL TYPE D) PER CFW STD. FW.M15.10
- 18 PROFILED PLASTIC WIDE DOTTED LINE (MATERIAL TYPE D) PER CFW STD. FW.M20.10
- 19 PROFILED PLASTIC DOTTED EXTENSION LINE (MATERIAL TYPE D) PER CFW STD. FW.M20.10
- 20 PLASTIC TRAFFIC LETTER PER WSDOT STD. PLAN M-80.10-01e
- 21 PLASTIC YIELD LINE SYMBOL PER CFW STD. FW.M15.10 (MATERIAL TYPE A)
- 22 PLASTIC TRAFFIC ARROW PER CFW STD. FW.M15.10 (MATERIAL TYPE A)
- 23 MODIFICATION - RRFB SYSTEM WITH APS BUTTON ASSEMBLY PER CFW STD. FW.J24.20
- 24 ADJUST CATCH BASIN TO GRADE

**LEGEND**

- INSTALL YELLOW TUBULAR MARKER
- ⊕ PEDESTRIAN PUSH BUTTON AND POST
- HYDRANT MARKER
- ⚡ EXISTING MONUMENT ADJUST CASE & COVER
- △ MONUMENTS IN ISLAND PRESERVE AND PROTECT
- ⊕ MONUMENT TO BE UNCOVERED OR ESTABLISHED
- HMA CL. 1/2" PG58H-22
- CEMENT CONCRETE SIDEWALK
- MMA TRUNCATED DOME



33325 8th Avenue South  
Federal Way, WA 98003-6325  
(253) 835-2700  
www.federalwaywa.gov

BID SET



DRAFTED: D. MCINTOSH

DESIGNED: C. KINLOCH

REVIEWED: C. MULLEN

APPROVED: D. WINKLER



**DRAWING VERSION / REVISION LOG**

NO.	DATE	REVISION
1	06-MAY-2026	ADDENDUM #2

**21ST AVE SW PRESERVATION**  
**ROADWAY & CHANNELIZATION 8**  
**STA: 69+50 - 71+50**

CITY PROJECT #:

36253

SHT. 19

OF 28

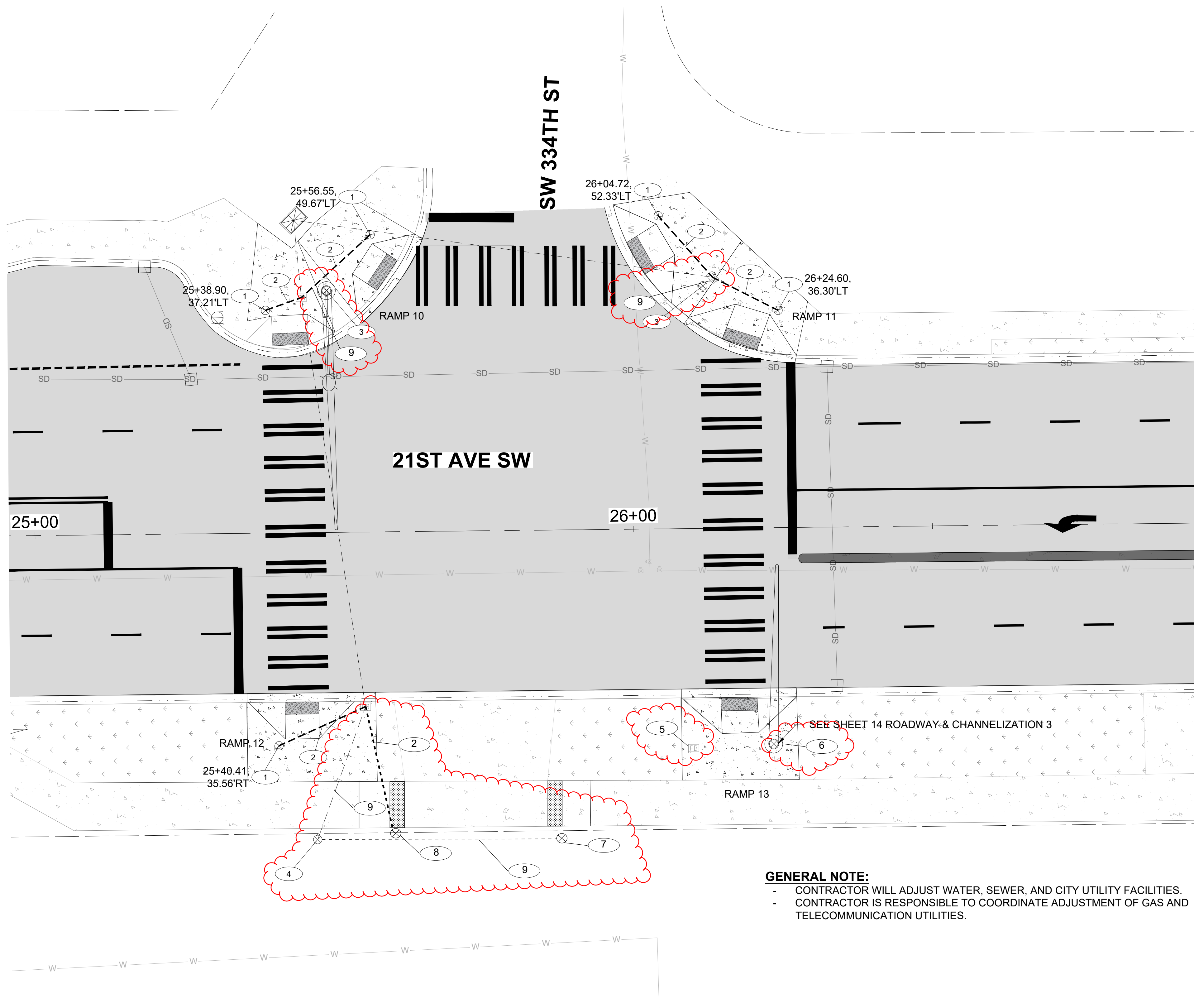
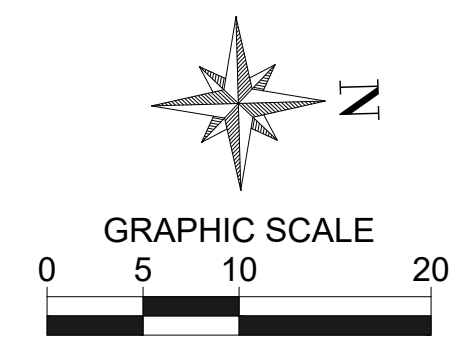

**INTERSECTION CONSTRUCTION NOTES:**

- 1 NEW PPB POLE WITH APS BUTTONS AND FOUNDATION PER STANDARD DETAIL FW J-20.10.
- 2 2-IN SCH80 CONDUIT WITH TWO-CONDUCTOR SHIELDED CABLE AND 4-CONDUCTOR CABLE PER 8-20.3(6) AND 9-29.3(2)E.
- 3 REMOVE EXISTING PUSH BUTTONS FROM SIGNAL POLE. REPAIR HOLES PER WSDOT STANDARD PLAN IS-17. INSTALL PED HEAD CONTROL UNIT IN EACH PEDESTRIAN SIGNAL HEAD.
- 4 REMOVE EXISTING PEDESTRIAN PUSH BUTTONS. REPAIR HOLES PER WSDOT STANDARD PLAN IS-17. MAINTAIN WALK / DON'T WALK HEADS. INSTALL PED HEAD CONTROL UNIT IN EACH PEDESTRIAN SIGNAL HEAD.
- 5 APPLY NON-SLIP COATING TO EXISTING JUNCTION BOX.
- 6 REMOVE EXISTING PEDESTRIAN PUSH BUTTON AND REPLACE WITH NEW APS PEDESTRIAN PUSH BUTTON ASSEMBLY. REPAIR HOLES PER WSDOT STANDARD PLAN IS-17. INSTALL PED HEAD CONTROL UNIT IN EACH PEDESTRIAN SIGNAL HEAD. CONTRACTOR TO MAINTAIN 10" REACH WITH RAMP DESIGN.
- 7 REMOVE EXISTING PEDESTRIAN PUSH BUTTON AND REPLACE WITH NEW APS PEDESTRIAN PUSH BUTTON ASSEMBLY. REPAIR HOLES PER WSDOT STANDARD PLAN IS-17. INSTALL PED HEAD CONTROL UNIT IN EACH PEDESTRIAN SIGNAL HEAD. CONTRACTOR TO TRIM VEGETATION, REMOVE EXTRUDED CURB, AND/OR POUR CONCRETE PAD AS NECESSARY IN ORDER TO MAINTAIN 10" REACH.
- 8 NEW PPB POLE WITH APS BUTTON AND FOUNDATION PER STANDARD DETAIL FW J-20.10. CONTRACTOR TO TRIM VEGETATION, REMOVE EXTRUDED CURB, AND/OR POUR CONCRETE PAD AS NECESSARY IN ORDER TO MAINTAIN 10" REACH.
- 9 EX. 2-IN SCH80 CONDUIT WITH NEW 4-CONDUCTOR CABLE(S) PER 9-29.3(2)E.

**GENERAL NOTE:**

- CONTRACTOR WILL ADJUST WATER, SEWER, AND CITY UTILITY FACILITIES.
- CONTRACTOR IS RESPONSIBLE TO COORDINATE ADJUSTMENT OF GAS AND TELECOMMUNICATION UTILITIES.

**CITY OF Federal Way**  
Centered on Opportunity  
33325 8th Avenue South  
Federal Way, WA 98003-6325  
(253) 835-2700  
www.federalwaywa.gov

**BID SET**  
**811**  
Know what's below.  
Call 811 before you dig

DRAFTED: D. MCINTOSH  
DESIGNED: C. KINLOCH  
REVIEWED: C. MULLEN  
APPROVED: D. WINKLER

Christine J. Mullen  
17-Apr-2026

DRAWING VERSION / REVISION LOG		
NO.	DATE	REVISION
1	06-MAY-2026	ADDENDUM #2

**21ST AVE SW PRESERVATION**  
**INTX - 21ST AVE SW & SW 334TH ST**

CITY PROJECT #:  
**36253**  
SHT. **20**  
OF **28**

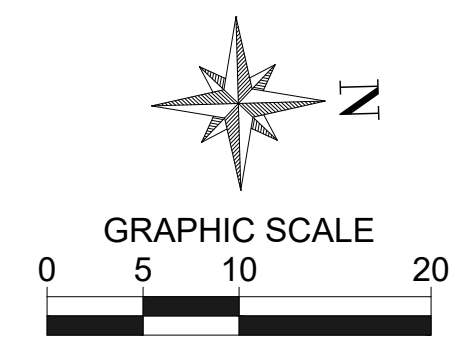

SW 325TH PL

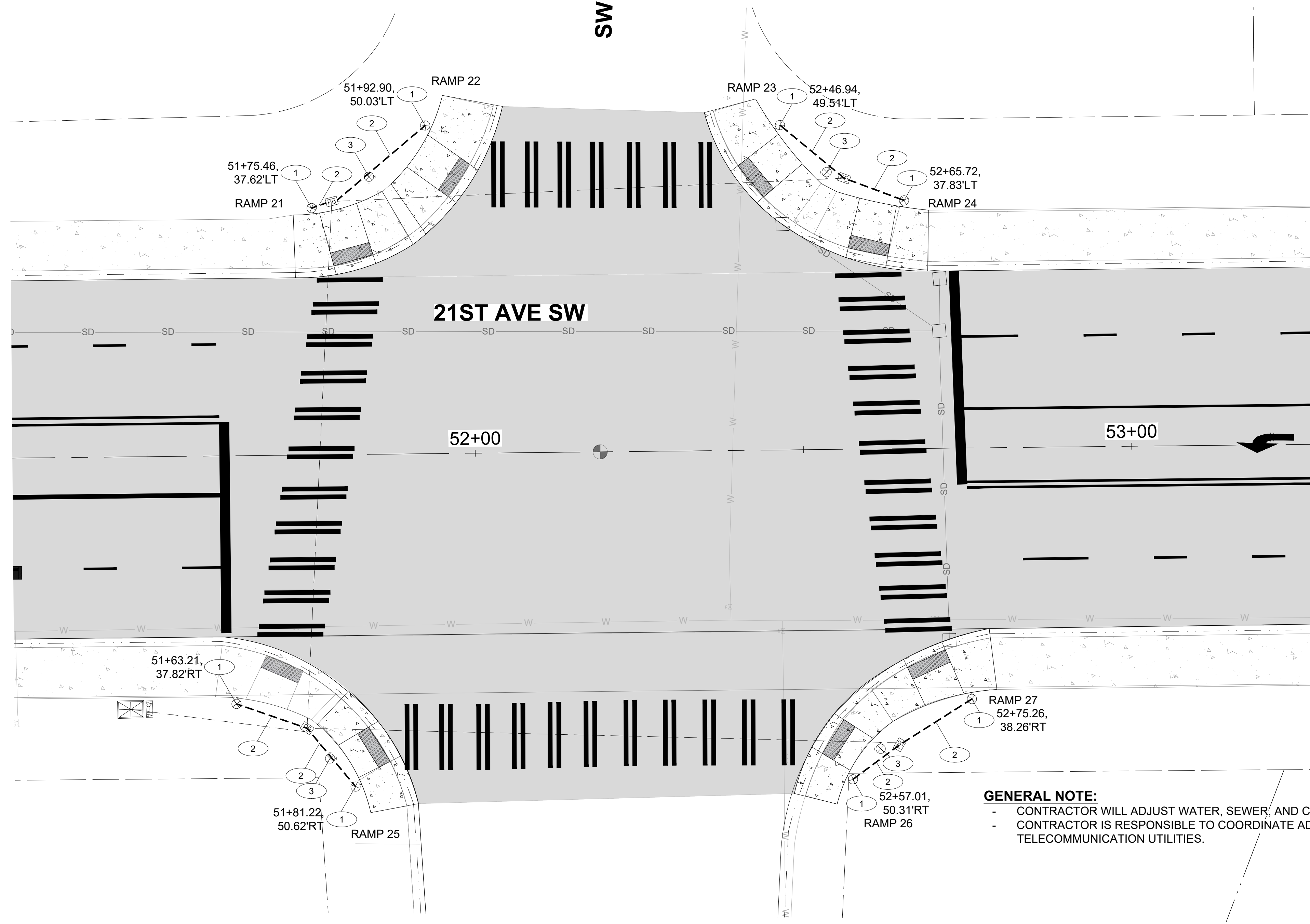

**INTERSECTION CONSTRUCTION NOTES:**

- 1 NEW PPB POLE WITH APS BUTTONS AND FOUNDATION PER STANDARD DETAIL FW J-20.10.
- 2 2-IN SCH80 CONDUIT WITH TWO-CONDUCTOR SHIELDED CABLE AND 4-CONDUCTOR CABLE PER 8-20.3(6) AND 9-29.3(2)E.
- 3 REMOVE EXISTING PUSH BUTTONS FROM SIGNAL POLE. REPAIR HOLES PER WSDOT STANDARD PLAN IS-17.

**GENERAL NOTE:**  
 - CONTRACTOR WILL ADJUST WATER, SEWER, AND CITY UTILITY FACILITIES.  
 - CONTRACTOR IS RESPONSIBLE TO COORDINATE ADJUSTMENT OF GAS AND TELECOMMUNICATION UTILITIES.

**CITY OF Federal Way**  
 Centered on Opportunity  
 33325 8th Avenue South  
 Federal Way, WA 98003-6325  
 (253) 835-2700  
 www.federalwaywa.gov

**BID SET**  
  
 Know what's below.  
 Call 811 before you dig.

DRAFTED: D. MCINTOSH  
 DESIGNED: C. KINLOCH  
 REVIEWED: C. MULLEN  
 APPROVED: D. WINKLER

DRAWING VERSION / REVISION LOG		
NO.	DATE	REVISION
1	06-MAY-2026	ADDENDUM #2

**21ST AVE SW PRESERVATION**  
**INTX - 21ST AVE SW & SW 325TH PL**

CITY PROJECT #:  
 36253  
 SHT. 21  
 OF 28